

Foot style

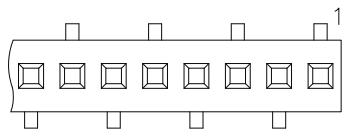

451

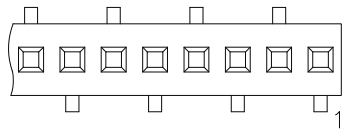
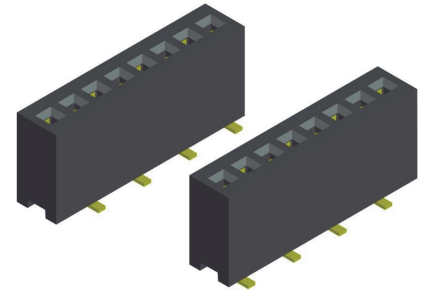

450

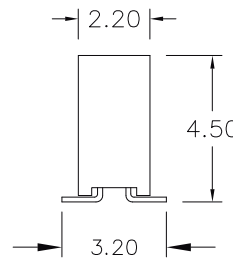
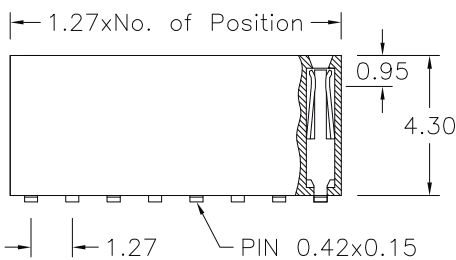

APPLICATION AND FEATURES

- **Standard: tube packing; without pick & place pad.**
- Also available with "pick & place pad" for automatic suck assembly to the PCB
- Low profile, 4.50mm height Type. Hi-rel dual beam contacts.
- Mating with 1.27mm pitch, 0.40mm square pin headers.
- Through Board mating possible

PCB Surface Mount & Hole Layout

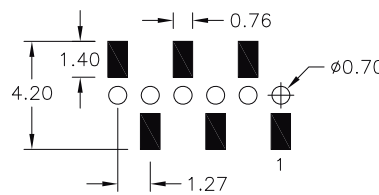

Foot style: 450

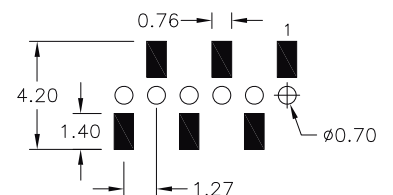

451

SPECIFICATIONS

Current rating	1 A	Operating temperature	- 40°C to +105°C
Insulator resistance	1000 MΩ min.	Processing temperature	+250°C +0/-5°C for 10sec.
Contact resistance	20 mΩ max.	Contact material (RoHS compliant)	Phosphor Bronze
Withstanding voltage	500 V AC	Insulator material (RoHS compliant)	LCP UL 94 V-0

How to order

BS 1 - xxx - H xxx - 55 /11 XX

Nbr of contacts	Foot style	Plating	Packing and "pick & place pad" Option
003 to 050	<p>450 Pls. choose 450 style if odd pin count.</p> <p>451 Foot style see above detail</p>	55 = gold	<p>A = tube packing; with pick & place pad</p> <p>B = reel packing; with pick & place pad</p> <p>AT = tube packing; with film pad</p> <p>BT = reel packing; with film pad</p>