

RoHS Compliant

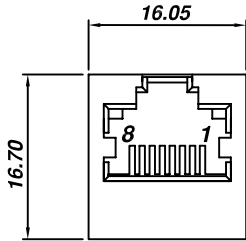

SHIELDED

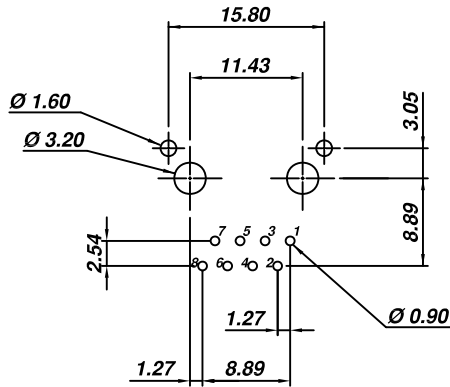
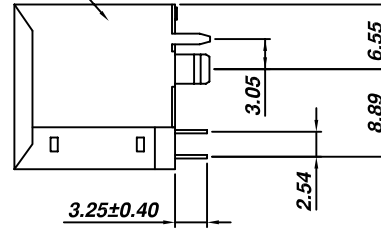

PCB LAYOUT
(Top View)

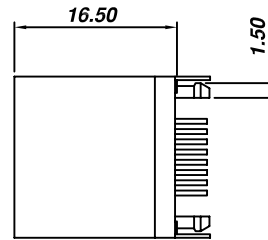

SPECIFICATION :

1. Electrical Char.

- Insulation Resistance : 500M-Ohm Min.
- Contact Resistance : 20milli-Ohm Max.
- Rating Current : 1.5A Max.
- Rating Voltage : 120V AC.
- Dielectric Voltage : 1,000 Vrms 60 Sec. Min.

2. Physical char.

- Housing (Option) :
 - PBT Glass Filled (UL 94V-0), Soldering Temperature:235°C
 - Nylon (UL 94V-0), Soldering Temperature:260°C
- Color : Black Color
- Spring Wire :
 - 0.35mm Thickness Phosphor bronze Gold Plating Over Nickel
- Shielded : Brass Plating Nickel
- Temperature Range : - 40°C / +85°C
- Durability : 500 Mating cycles Min.

AJ-012SH-9-F-XX-A1-N1

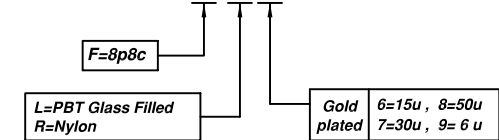

TITLE	
RJ45 TOP ENTRY SHIELDED PCB JACK UL & cUL FILE NO. E131820	
MODULAR JACKS ASSY FOR AJ-012SH-9-F-XX-A1-N1	
SCALE SIZE DWG. NO. 9628-S SERIES	

DWG. NO.	NOT SCALED DRAWING	TOLERANCE UNLESS OTHERWISE NOTICE	INCH	MM	DR.	DATE
		LINEAR	MM INCH	00±0.01 000±0.005 0000±0.002	00±0.25 000±0.13 0000±0.05	<i>Steven</i> DEC-03 '07
	MM INCH	ANGLE +0°30'	RADIL	+0.45 -0.15	<i>John</i> DEC-03 '07 <i>Billy</i> DEC-03 '07	

AS012014-1

SPECIFICATION :

1. Electrical Char.

- Insulation Resistance : 500M-Ohm Min.
- Contact Resistance : 20milli-Ohm Max.
- Rating Current : 1.5A Max.
- Rating Voltage : 120V AC.
- Dielectric Voltage : 1,000 Vrms 60 Sec. Min.

2. Physical char.

- Housing : PBT Glass Filled (UL 94V-0)
- Color : Black Color
- Spring Wire : 0.45mm Dia. Phosphor bronze
Nickel Plated and with 6u Gold Plated.
- Temperature Range : - 40°C / +85°C
- Durability : 500 Mating cycles Min.

AJ-008SH-8-F-L4-B1-N1

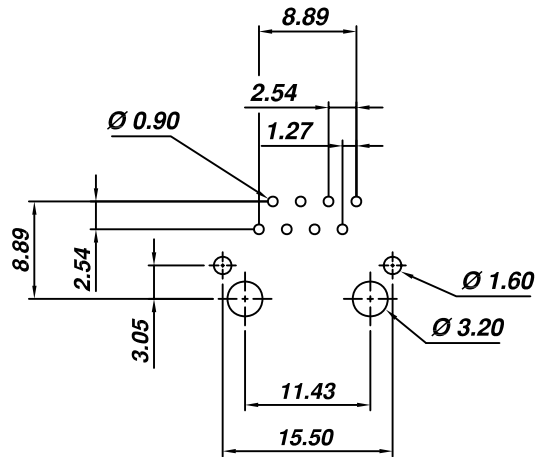
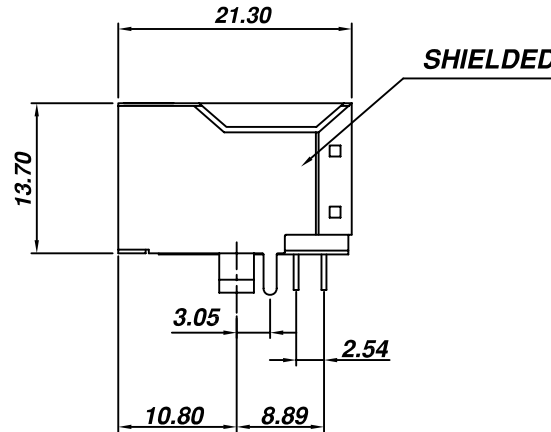
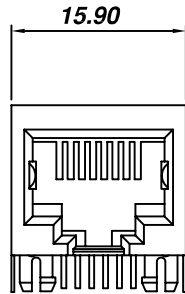

PCB LAYOUT
(Top View)

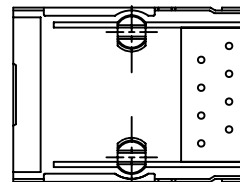

TITLE	
RJ45 SIDE ENTRY SHIELDED PCB JACK UL & cUL FILE NO. E131820	
MODULAR JACKS ASSY FOR AJ-008SH-8-F-L4-B1-N1	
SCALE SIZE DWG. NO. 9638S SERIES	

DWG. NO.	AS008016-1W
----------	--------------------

NOT SCALED DRAWING	TOLERANCE UNLESS OTHERWISE NOTICE	INCH	MM	DR.	DATE
THIRD ANGLE PROJECTION	LINEAR	MM INCH	00±0.01 000±0.005 0000±0.002	00±0.25 000±0.13 0000±0.05	Steven MAR-01 '06
	ANGLE +0°30'	RADIL	+0.45 -0.15	John APP'D Billy MAR-01 '06	