

120/121M111

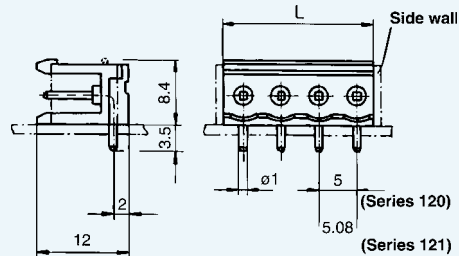

120/121M121

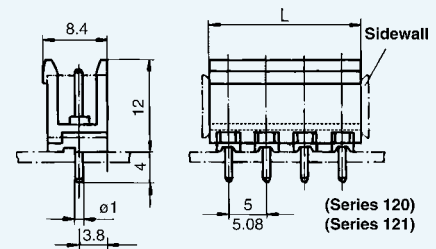

SECTION 2E

PLUGGABLE
PRINTED CIRCUIT
CONNECTORS

120M

L = Number of poles x 5mm

121M

L = Number of poles x 5.08mm



FEATURES

Series 120/121M pin headers are suitable for use with all 120/121 series socket connectors as shown on pages 77-79. They can be supplied in vertical or horizontal format, with or without side walls and in 5mm pitch (type 120) or 5.08mm pitch (type 121). They are available in 2 to 24 pole lengths

TECHNICAL DATA

Mouldings:	Nylon 6.6, grey, UL94 V0
Solder pins:	Brass, tinned
Current rating:	12 amp
Voltage rating:	600V ~ to VDE 0110, pollution degree 2. Creepage and clearance distance > 3.2mm. Breakdown voltage 2500V ~
Tracking distance:	CTI > 600
Maximum temp:	80°C
Pin spacing:	120 - 5mm 121 - 5.08mm
Recommended hole dia in p.c.board:	1.4mm

APPROVALS

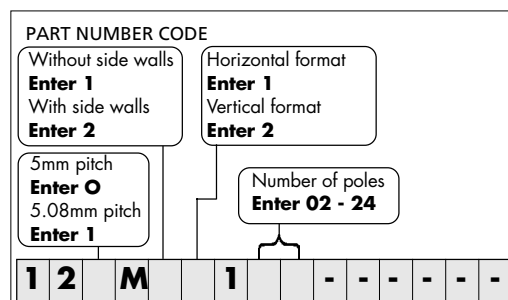

OPTIONS

Marking: consecutive numbering, lettering or special printing available. Please provide sketch.

Pitch: also available in 10mm pitch, details upon request.

Pins: can be supplied with pins up to 75mm in length.