

USB Connector

Unit: $\frac{\text{mm}}{\text{Inch}}$

Specifications

Current rating: 1A AC DC
 Voltage rating: 30V AC DC
 Temperature rating: $-25^{\circ}\text{C} \sim +85^{\circ}\text{C}$
 Contact resistance: 30m Ω max.
 Insulation resistance: 1000M Ω min.
 Withstanding voltage: 750V AC/min.

Standards

Recognized No. E82349

RoHS Compliant

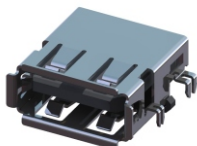

2075 Series USB A Type Receptacle

2075S0*04*Z

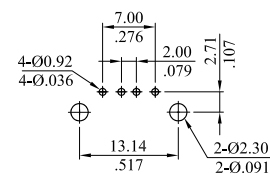
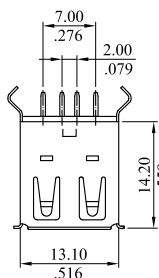
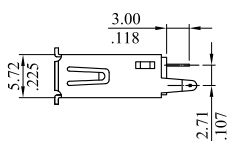
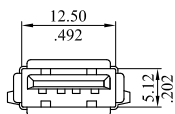

Recommended PCB Layout

2075S0*07*Z

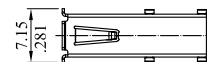
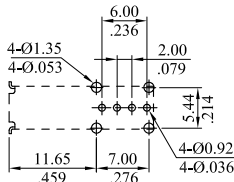
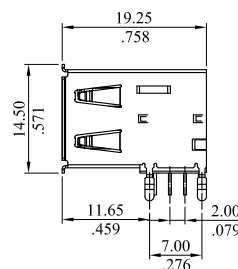
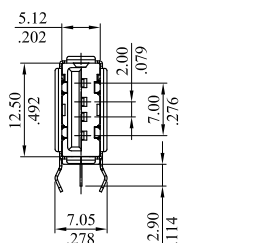

Recommended PCB Layout

2075S0*0L*0

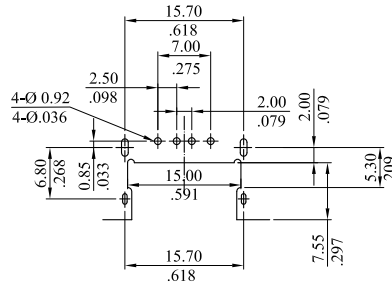
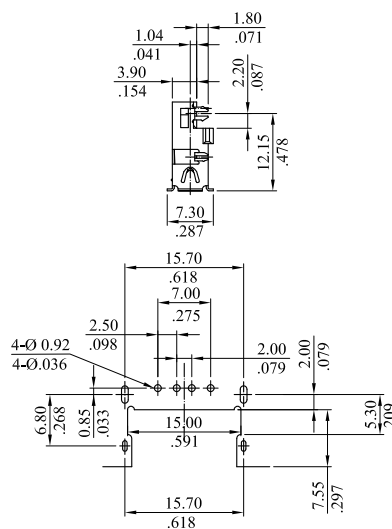
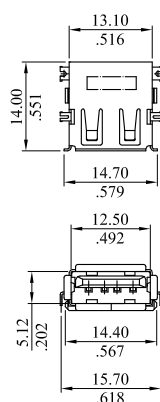

Recommended PCB Layout

Features

2075 USB Receptacle:
 Fully compliant with current
 USB 2.0 specifications
 Dynamically attachable and
 detachable
 Isochronous and asynchronous
 bi-directional data transfers
 Self-identifying peripherals with
 automatic mapping of function to
 driver
 Standard connector for all
 devices

P/N 2075 S 0 * 0 * * * *
 1 2 3 4 5 6 7

1. Socket
2. 0=Single
3. Contact plating
 F=Selective gold flash
 over 50u"min. nickel
 J=15u"min. Selective gold
 plated over 50u"min. nickel
 K=30u"min. Selective gold
 plated over 50u"min. nickel
4. 0=A type
5. Type
 4=V type
 7=H type (side pin)
 L=Low profile type
6. Color
 0=Beige (Ivory)
 1=Black
 2=White
7. Special option

USB Connector

Unit: $\frac{\text{mm}}{\text{Inch}}$

Specifications

Current rating: 1A AC DC
 Voltage rating: 30V AC DC
 Temperature rating: $-25^{\circ}\text{C} \sim +85^{\circ}\text{C}$
 Contact resistance: 30m Ω max.
 Insulation resistance: 1000M Ω min.
 Withstanding voltage: 750V AC/min.

Standards

Recognized No. E82349

RoHS Compliant

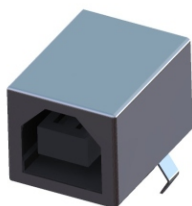

2075 Series USB A Type Receptacle

2075S0*0**L

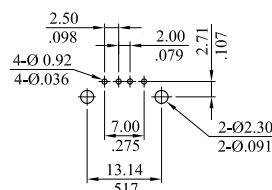
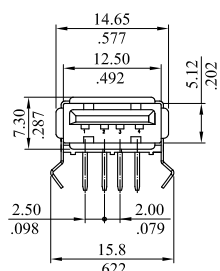
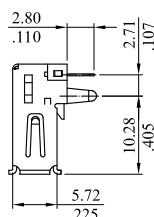
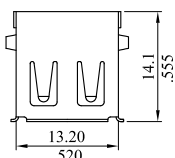

Recommended PCB Layout

2075S1*0**Z

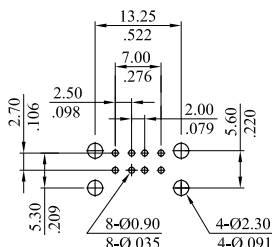
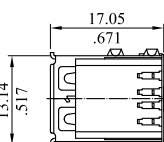
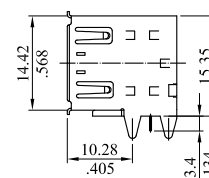
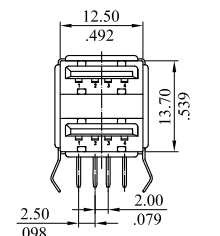

Recommended PCB Layout

Features

2075 USB Receptacle:
 Fully compliant with current USB 2.0 specifications
 Dynamically attachable and detachable
 Isochronous and asynchronous bi-directional data transfers
 Self-identifying peripherals with automatic mapping of function to driver
 Standard connector for all devices

P/N 2075 S * * 0 * * *
 1 2 3 4 5 6 7

1. Socket
2. 0=Single 1=Stack
3. Contact plating
 F=Selective gold flash over 50u"min. nickel
 J=15u"min. Selective gold plated over 50u"min. nickel
 K=30u"min. Selective gold plated over 50u"min. nickel
4. 0=A type
5. Type
 0=H type
 1=H type+rear shell
6. Color
 0=Beige (Ivory)
 1=Black
 2=White
7. Special option

2075 Series USB B Type Receptacle

2075S0*B1*Z

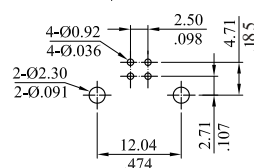
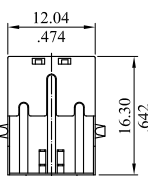
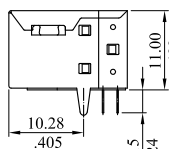
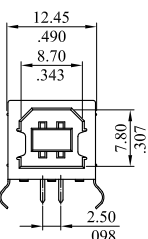

Recommended PCB Layout

P/N 2075 S 0 * B 1 * Z
 1 2 3 4 5 6 7

1. Socket
2. 0=Single
3. Contact plating
 F=Selective gold flash over 50u"min. nickel
 J=15u"min. Selective gold plated over 50u"min. nickel
 K=30u"min. Selective gold plated over 50u"min. nickel
4. B=B type
5. Type
 1=H type+rear shell
6. Color
 0=Beige (Ivory)
 1=Black
 2=White
7. Special option

USB Connector

Unit: $\frac{\text{mm}}{\text{Inch}}$

Specifications

Current rating: 1A AC DC
 Voltage rating: 30V AC DC
 Temperature rating: $-25^{\circ}\text{C} \sim +85^{\circ}\text{C}$
 Contact resistance: 30m Ω max.
 Insulation resistance: 1000M Ω min.
 Withstanding voltage: 750V AC/min.

Standards

Recognized No. E82349

RoHS Compliant

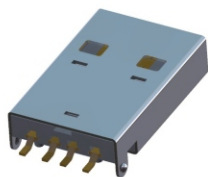
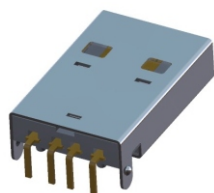

2076 Series USB A Type Plug

2076P0*0T*L

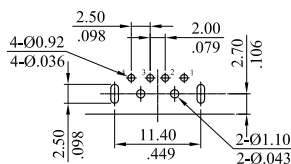
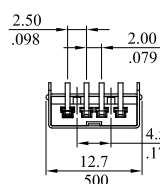
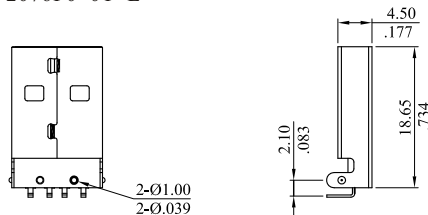

Recommended PCB Layout

2076P0*0M*L

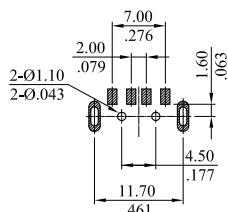
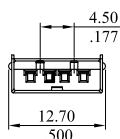
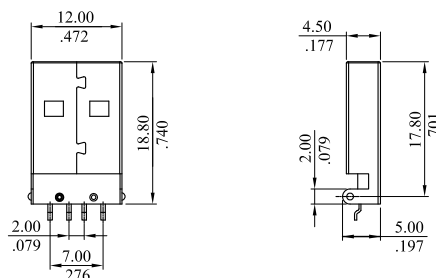

Recommended PCB Layout

Features

2076 USB Plug:
 Supports up to 126 devices
 Up to 5 meters per cable segment
 Low cost solution that can transfer 12 Mbit/sec data rates
 Dynamically attachable and detachable
 Isochronous and asynchronous bi-directional data transfers
 Self-identifying peripherals with automatic mapping of function to driver
 Standard connector for all devices

P/N 2076 P 0 * 0 * * L
1 2 3 4 5 6 7

1. Plug
2. 0=Single
3. Contact plating
 F=Selective gold flash over 50u"min. nickel
 J=15u"min. Selective gold plated over 50u"min. nickel
 K=30u"min. Selective gold plated over 50u"min. nickel
4. 0=A type
5. Type
 M=SMT
 T=Through hole
6. Color
 0=Beige (Ivory)
 1=Black
 2=White
7. Special option

Mini USB Connector

Unit: $\frac{\text{mm}}{\text{Inch}}$

Specifications

Current rating: 1A AC DC
 Voltage rating: 30V AC DC
 Temperature rating: -25°C~+85°C
 Contact resistance: 50mΩ max.
 Insulation resistance: 100 MΩ min.
 Withstanding voltage: 100V AC/min.

Standards

RoHS Compliant

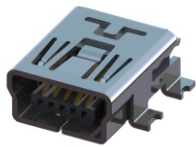

Mini USB 5 Circuits SMT Type Receptacle

MUSBS5*BM*2

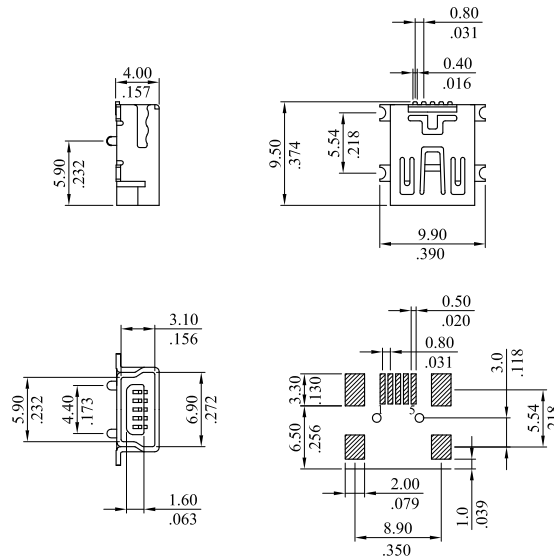

Recommended PCB Layout

Features

MUSB Receptacle:
 Fully compliant with current USB 2.0 specifications
 Smaller and lighter than exiting USB connector for portable and handheld devices

P/N MUSBS5*BM*2
 1 2 3 4 5 6 7

- Series No.
- S=Socket
- No. of contacts
5=5 pin
- plating
 F=Selective glod flash over 30u"min. nickel overall
 J=Selective 15u"min. glod over 30u"min. nickel overall
 K=Selective 30u"min. gold over 30u"min. nickel overall
- B=B Type
- M=SMT Type
- Color
0=White 1=Black

Micro USB Connector

Unit: $\frac{\text{mm}}{\text{Inch}}$

Specifications

Current rating:
 When applying current only to signal terminals:
 1.0 A (for terminal No.2, 3 and 4)
 When applying current to the power terminal:
 1.8 A (for terminal No.1 and 5),
 0.5 A (for terminal No.2, 3 and 4)
 Voltage rating: 30V AC DC
 Temperature rating: $-25^{\circ}\text{C} \sim +85^{\circ}\text{C}$
 Contact resistance: 30m Ω max.
 Insulation resistance: 100 M Ω min.
 Withstanding voltage: 100V AC/min.

Standards

RoHS Compliant

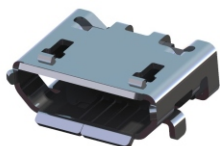

Micro USB B Type SMT Type Receptacle

0650SBBD300

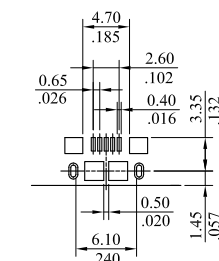
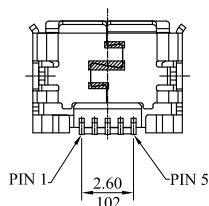
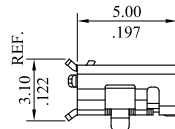
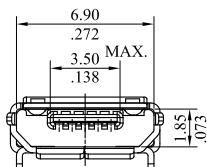

Recommended PCB Layout

Features

0650 Receptacle:
 Fully compliant with current USB 2.0 specifications
 Smaller and lighter than exiting USB connector for portable and handheld devices

P/N **0650 S B * * * 0 0**
1 2 3 4 5 6 7 8

- Series No.
- Contact & Connection Type
S=Socket
- Construction Type
B=Micro B Type
- Tail style
A=Shell:T/H,Contact:SMT
B=Shell:T/H and SMT, Contact:SMT
- Contact Plating
F=Selective gold flash over 30u"min. nickel overall
K=Selective 30u"min. gold over 30u"min. nickel overall
D= Contact area Au 30u"min. Soldering area Au 1u"min. over 50u"min. nickel overall
- Base color and material
3=LCP, color:black
- Shell construction type
0=Shell Tin plated
1=Shell nickel plated
- Special option
0=Standard

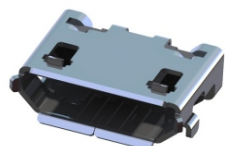

0650SBAD300

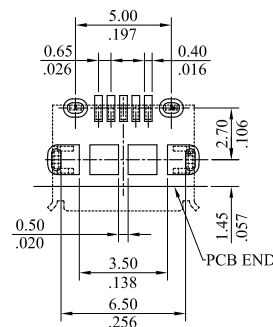
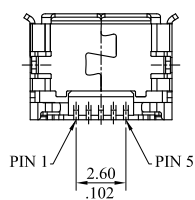
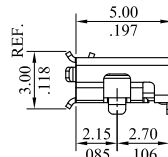
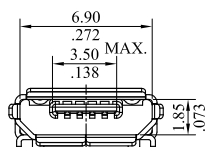

Recommended PCB Layout

USB 3.0 Connector

Unit: $\frac{\text{mm}}{\text{Inch}}$

Specifications

Current rating: 1A AC DC
 Voltage rating: 30V AC DC
 Temperature rating: $-40^{\circ}\text{C}\sim+60^{\circ}\text{C}$
 Contact resistance: 30m Ω max.
 Insulation resistance: 1000M Ω min.
 Withstanding voltage: 750V AC/min.

Standards

RoHS Compliant



2077 Series USB 3.0 A Type Receptacle

2077SAH**00

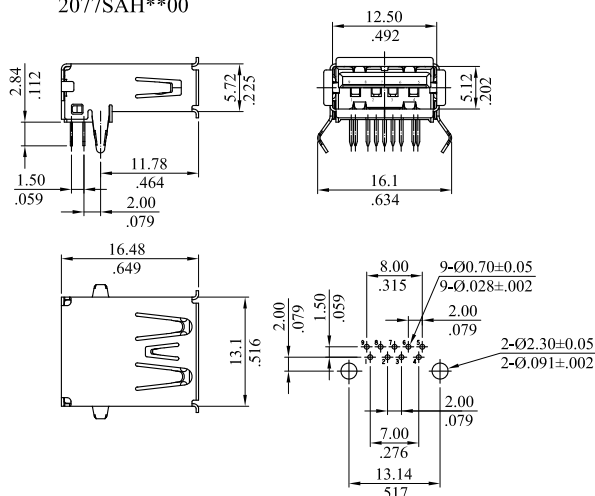

Recommended PCB Layout

Features

2077 Receptacle:
 Compliant with current USB 3.0 specification
 Backward compatible with 2.0
 Supports 5 Gbps data rate

P/N 2077 S A H * * 00
 1 2 3 4 5

1. S=Socket
2. A=Standard A type
3. H=Shell right angle and through hole
4. Contact plating
 J=15u"min. selective gold plated over 50u"min. nickel
 K=30u"min. selective gold plated over 50u"min. nickel
5. Color
 1=Black
 7=Blue (Standard)

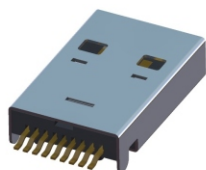

2077 Series USB 3.0 A Type Plug

2077PAM**00

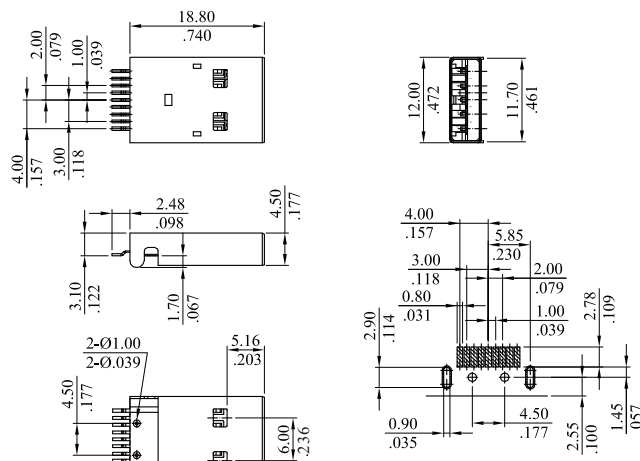

Recommended PCB Layout

THICKNESS=1.2mm

Features

2077 Plug:
 Compliant with current USB 3.0 specification
 Backward compatible with 2.0
 Supports 5 Gbps data rate

P/N 2077 P A M * * 00
 1 2 3 4 5

1. P=Plug
2. A=Standard A type
3. M=Shell right angle and SMT
4. Contact plating
 J=15u"min. selective gold plated over 50u"min. nickel
 K=30u"min. selective gold plated over 50u"min. nickel
5. Color
 1=Black
 7=Blue (Standard)

Specifications

Current rating: 0.5A AC DC
 Voltage rating: 30V AC DC
 Temperature rating: -25°C~+85°C
 Contact resistance: 20mΩ max.
 Insulation resistance: 100MΩ min.
 Withstanding voltage: 500V AC/min.

Standards

RoHS Compliant

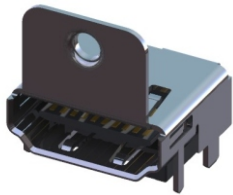
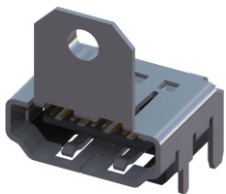

8500 Series HDMI SMT With Flange Type Receptacle

8500S19*T11

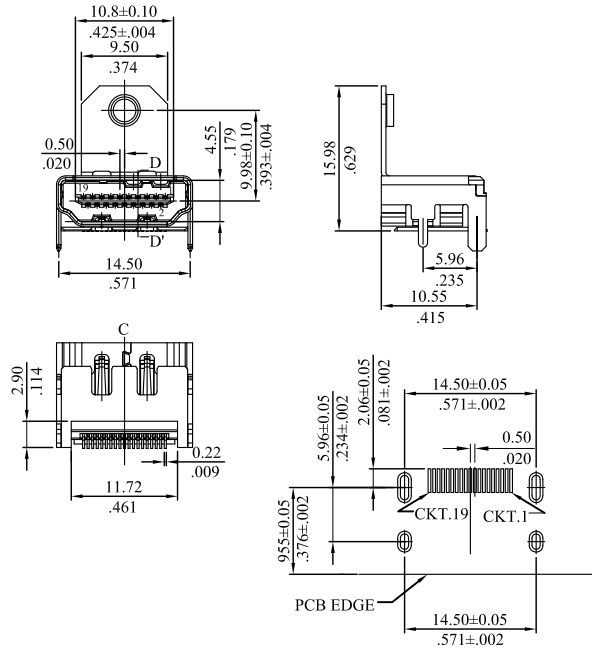

Recommended PCB Layout

Features

8500 Receptacle:
 Insulator: LCP UL94V-0
 Contact: Brass or phosphor bronze
 Shell: Steel/Tin or nickel plated
 Contact plating: Selective gold over nickel plated

P/N 8500S 19 * T 1 1
 1 2 3

- No. of circuits
- Contacts plating
 J=Selective 15u"min. gold
 K=Selective 30u"min. gold
- Shell material
 1=Shell material is copper alloy
 F=Shell material is SPCC

8500 Series HDMI DIP With Flange Type Receptacle

8500S19*E11

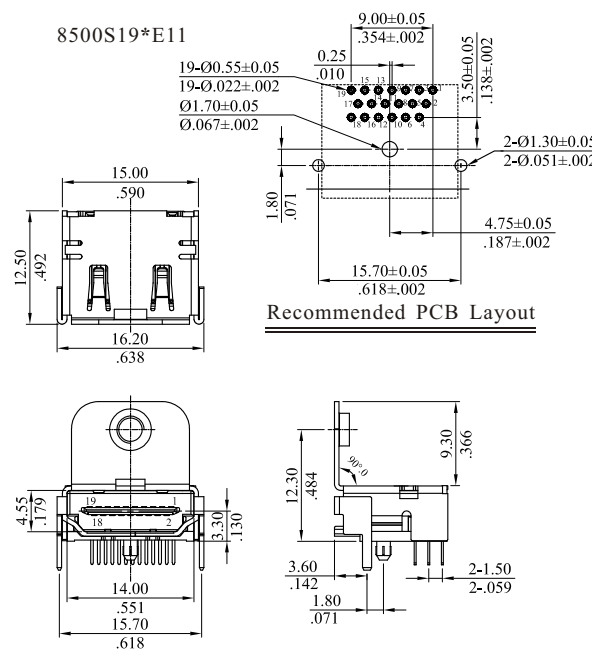

Recommended PCB Layout

Features

8500 Receptacle:
 Insulator: LCP UL94V-0
 Contact: Brass or phosphor bronze
 Shell: Steel/Tin or nickel plated
 Contact plating: Selective gold over nickel plated

P/N 8500S 19 * E 1 1
 1 2

- No. of circuits
- Contacts plating
 J=Selective 15u"min. gold
 K=Selective 30u"min. gold



High-Definition Multimedia Interface Connector

Unit: $\frac{\text{mm}}{\text{Inch}}$

Specifications

Current rating: 0.5A AC DC
 Voltage rating: 30V AC DC
 Temperature rating: -25°C~+85°C
 Contact resistance: 20mΩ max.
 Insulation resistance: 100MΩ min.
 Withstanding voltage: 500V AC/min.

Standards

RoHS Compliant
 HIGH DEFINITION MULTIMEDIA INTERFACE



8500 Series HDMI SMT Type Receptacle

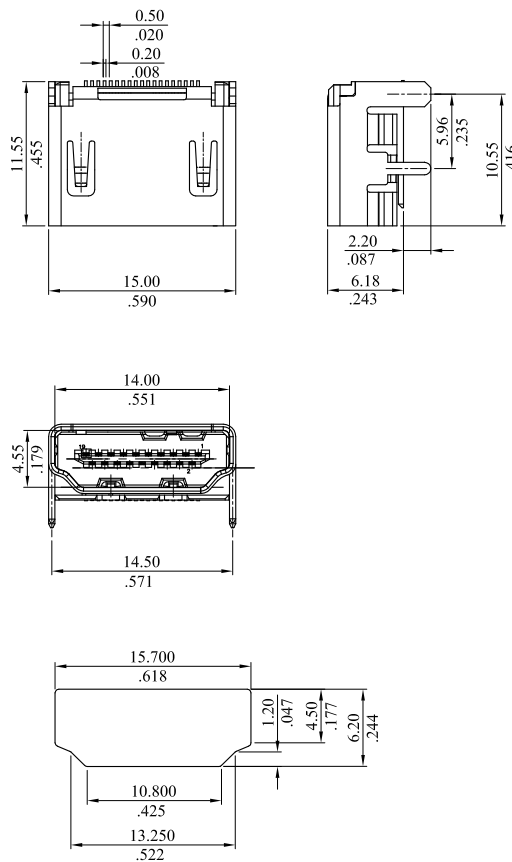

Features

8500 Receptacle:
 Insulator: LCP UL94V-0
 Contact: Brass or phosphor bronze
 Shell: Steel/Tin or nickel plated
 Contact plating: Selective gold over nickel plated

P/N 8500S 19 E T10
1 2

- No. of circuits
- Contacts plating
 - E=Selective 5u"min. gold
 - J=Selective 15u"min. gold
 - K=Selective 30u"min. gold

Recommended Panel Cut Out Dimension

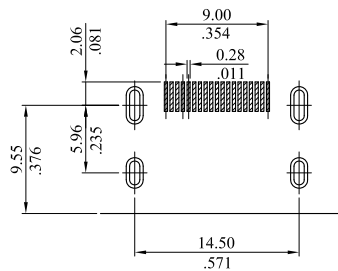

Recommended PCB Layout