

SPECIFICATIONS			
Current rating	0.5 A max.	Operating temperature	- 20°C to +85°C
Insulation resistance	500 MΩ min.	Processing temperature	+250°C +0/-5°C for 3sec.
Contact resistance	20 mΩ max.	Contact material	Phosphor Bronze
Withstanding voltage	200 V AC	Contact plating	Tin (<i>leadfree</i>)
		Insulator material	LCP UL 94 V-0

Dimensions (mm)											
Contacts	DIM "A"	DIM "B"	Contacts	DIM "A"	DIM "B"	Contacts	DIM "A"	DIM "B"	Contacts	DIM "A"	DIM "B"
004	6.50	2.60	019	14.00	10.10	034	21.50	17.60	049	29.00	25.10
005	7.00	3.10	020	14.50	10.60	035	22.00	18.10	050	29.50	25.60
006	7.50	3.60	021	15.00	11.10	036	22.50	18.60	051	30.00	26.10
007	8.00	4.10	022	15.50	11.60	037	23.00	19.10	052	30.50	26.60
008	8.50	4.60	023	16.00	12.10	038	23.50	19.60	053	31.00	27.10
009	9.00	5.10	024	16.50	12.60	039	24.00	20.10	054	31.50	27.60
010	9.50	5.60	025	17.00	13.10	040	24.50	20.60	055	32.00	28.10
011	10.00	6.10	026	17.50	13.60	041	25.00	21.10	056	32.50	28.60
012	10.50	6.60	027	18.00	14.10	042	25.50	21.60	057	33.00	29.10
013	11.00	7.10	028	18.50	14.60	043	26.00	22.10	058	33.50	29.60
014	11.50	7.60	029	19.00	15.10	044	26.50	22.60	059	34.00	30.10
015	12.00	8.10	030	19.50	15.60	045	27.00	23.10	060	34.50	30.60
016	12.50	8.60	031	20.00	16.10	046	27.50	23.60			
017	13.00	9.10	032	20.50	16.60	047	28.00	24.10			
018	13.50	9.60	033	21.00	17.10	048	28.50	24.60			

How to order

FCZ - xxx - VC xx - 99/RT

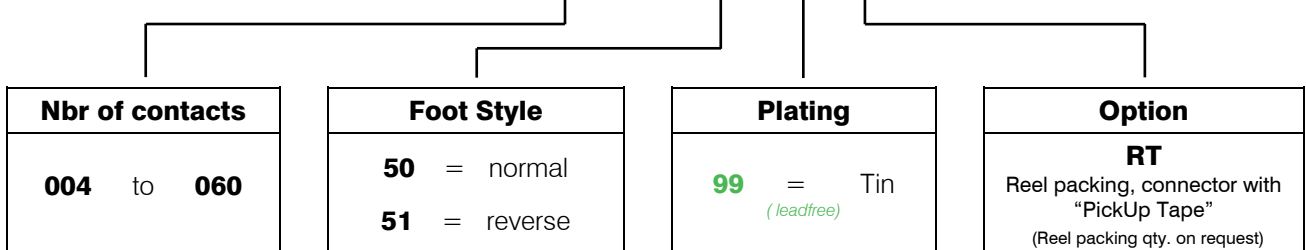

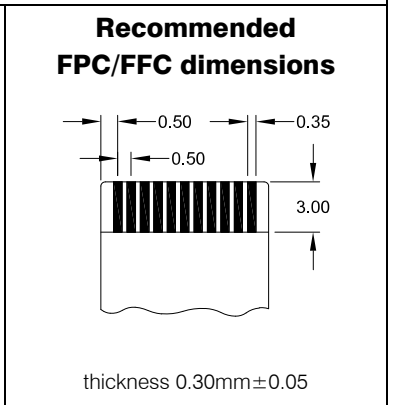
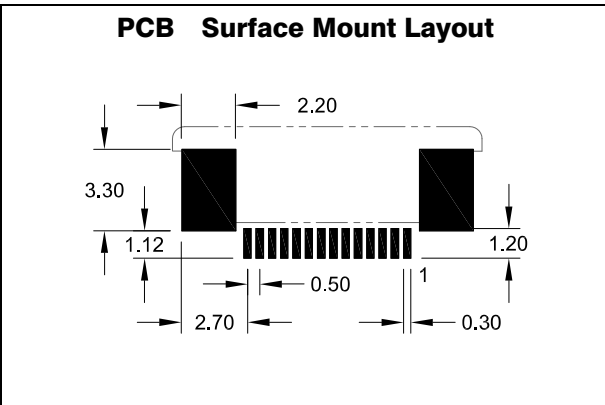
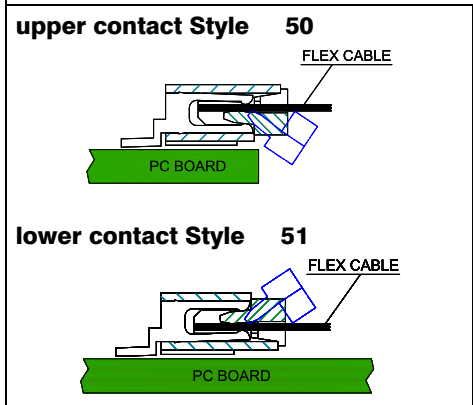
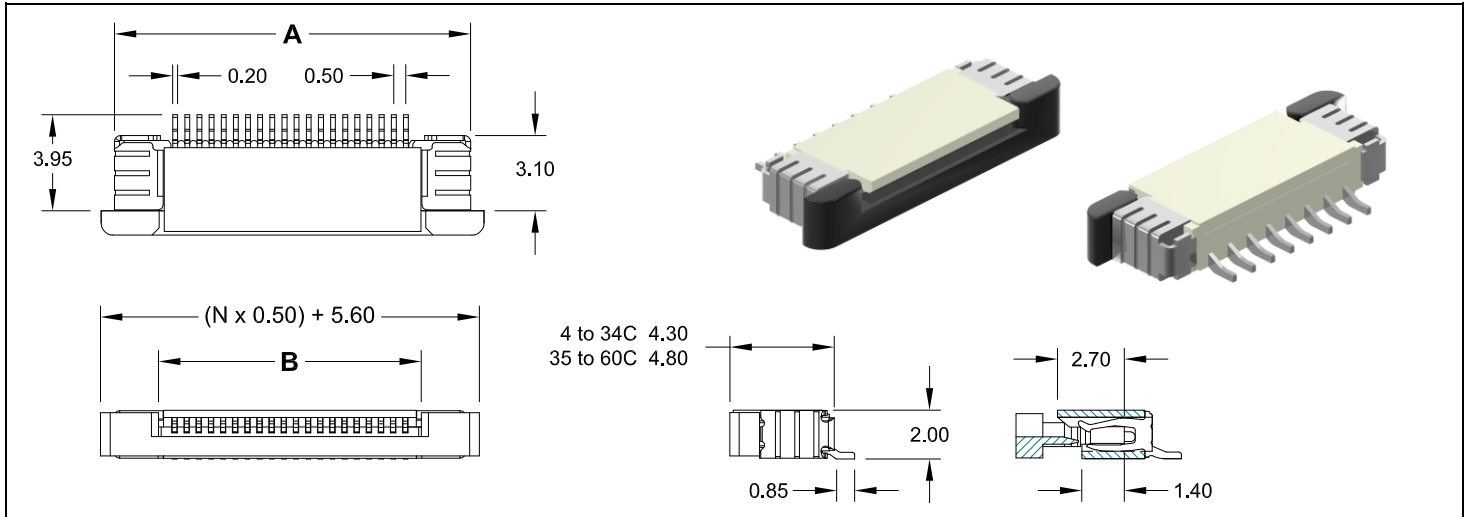

SPECIFICATIONS			
Current rating	0.5 A max.	Operating temperature	- 20°C to +85°C
Insulation resistance	500 MΩ min.	Processing temperature	+250°C +0/-5°C for 3sec.
Contact resistance	20 mΩ max.	Contact material	Phosphor Bronze (RoHS compliant)
Withstanding voltage	200 V AC	Contact plating	Tin (leadfree)
		Insulator material	LCP (RoHS compliant) UL 94 V-0

Dimensions (mm)											
Contacts	DIM "A"	DIM "B"	Contacts	DIM "A"	DIM "B"	Contacts	DIM "A"	DIM "B"	Contacts	DIM "A"	DIM "B"
004	6.50	2.60	019	14.00	10.10	034	21.50	17.60	049	29.00	25.10
005	7.00	3.10	020	14.50	10.60	035	22.00	18.10	050	29.50	25.60
006	7.50	3.60	021	15.00	11.10	036	22.50	18.60	051	30.00	26.10
007	8.00	4.10	022	15.50	11.60	037	23.00	19.10	052	30.50	26.60
008	8.50	4.60	023	16.00	12.10	038	23.50	19.60	053	31.00	27.10
009	9.00	5.10	024	16.50	12.60	039	24.00	20.10	054	31.50	27.60
010	9.50	5.60	025	17.00	13.10	040	24.50	20.60	055	32.00	28.10
011	10.00	6.10	026	17.50	13.60	041	25.00	21.10	056	32.50	28.60
012	10.50	6.60	027	18.00	14.10	042	25.50	21.60	057	33.00	29.10
013	11.00	7.10	028	18.50	14.60	043	26.00	22.10	058	33.50	29.60
014	11.50	7.60	029	19.00	15.10	044	26.50	22.60	059	34.00	30.10
015	12.00	8.10	030	19.50	15.60	045	27.00	23.10	060	34.50	30.60
016	12.50	8.60	031	20.00	16.10	046	27.50	23.60			
017	13.00	9.10	032	20.50	16.60	047	28.00	24.10			
018	13.50	9.60	033	21.00	17.10	048	28.50	24.60			

How to order

FCZ - xxx - HC xx - 99 /R

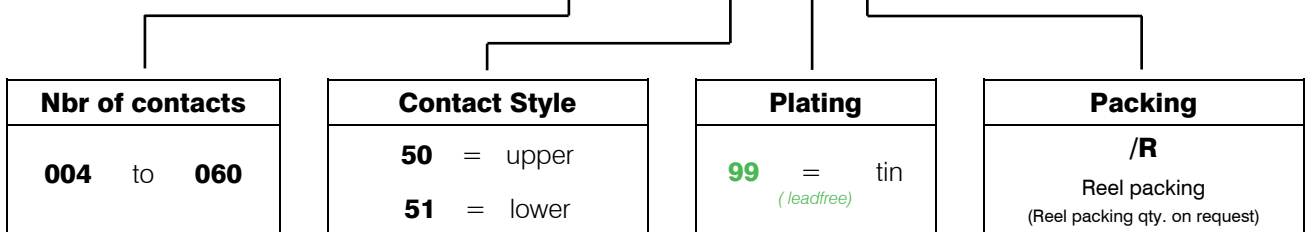

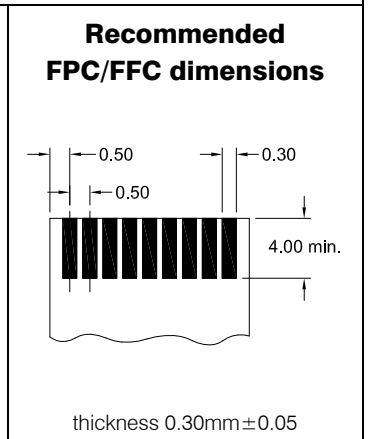
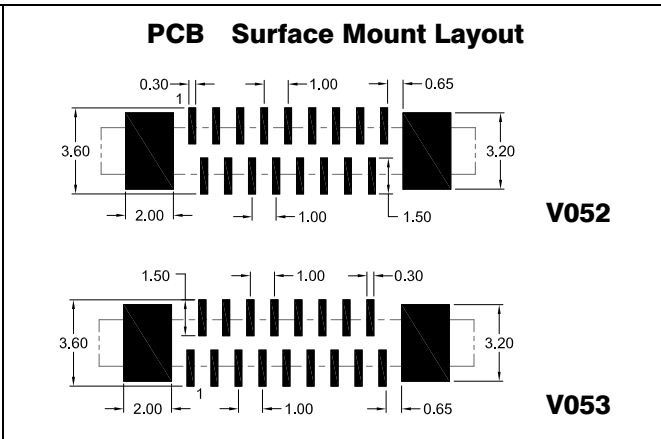
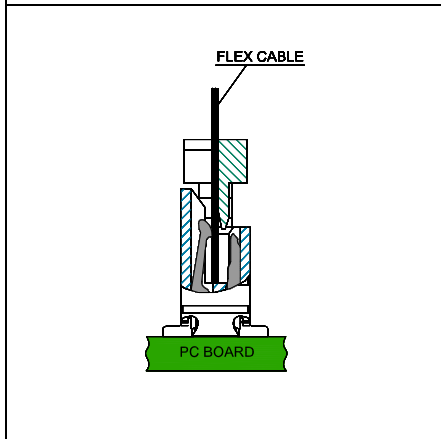
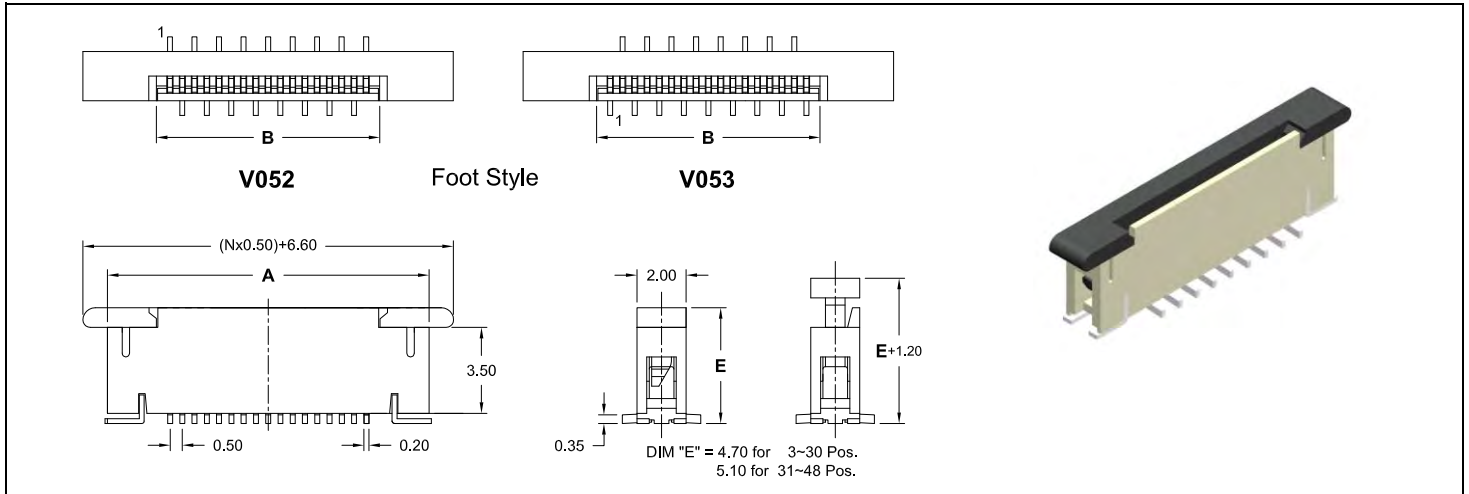

Specifications

Current rating	0.5 A max.	Operating temperature	-20°C to +85°C
Insulation resistance	500 MΩ min.	Processing temperature	+250°C +0/-5°C for 3sec.
Contact resistance	20 mΩ max.	Contact material	Phosphor Bronze (RoHS compliant)
Withstanding voltage	200 V AC	Contact plating	Tin (leadfree)
		Insulator material	PA46 UL 94 V-0 (RoHS compliant)
		Actuator material	PA9T UL 94 V-0 (RoHS compliant)

Dimensions (mm)

Contacts	DIM "A"	DIM "B"	Contacts	DIM "A"	DIM "B"	Contacts	DIM "A"	DIM "B"	Contacts	DIM "A"	DIM "B"
003	8.10	2.10	015	14.10	8.10	027	20.10	14.10	039	26.10	20.10
004	8.60	2.60	016	14.60	8.60	028	20.60	14.60	040	26.60	20.60
005	9.10	3.10	017	15.10	9.10	029	21.10	15.10	041	27.10	21.10
006	9.60	3.60	018	15.60	9.60	030	21.60	15.60	042	27.60	21.60
007	10.10	4.10	019	16.10	10.10	031	22.10	16.10	043	28.10	22.10
008	10.60	4.60	020	16.60	10.60	032	22.60	16.60	044	28.60	22.60
009	11.10	5.10	021	17.10	11.10	033	23.10	17.10	045	29.10	23.10
010	11.60	5.60	022	17.60	11.60	034	23.60	17.60	046	29.60	23.60
011	12.10	6.10	023	18.10	12.10	035	24.10	18.10	047	30.10	24.10
012	12.60	6.60	024	18.60	12.60	036	24.60	18.60	048	30.60	24.60
013	13.10	7.10	025	19.10	13.10	037	25.10	19.10			
014	13.60	7.60	026	19.60	13.60	038	25.60	19.60			

How to order

FCZ - xxx - V xxx - 99 /X

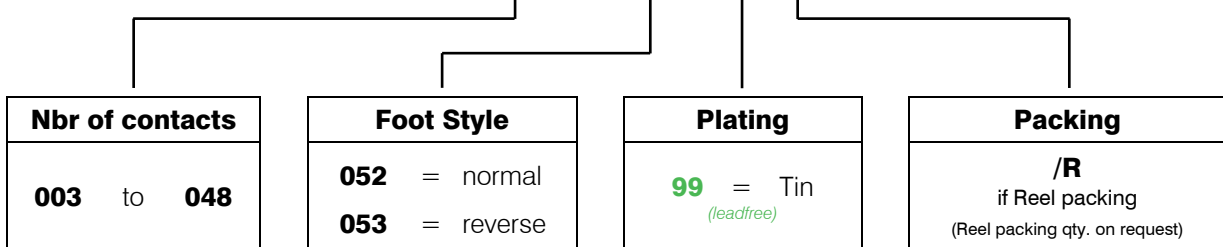

- SMT - 0.50mm pitch horizontal

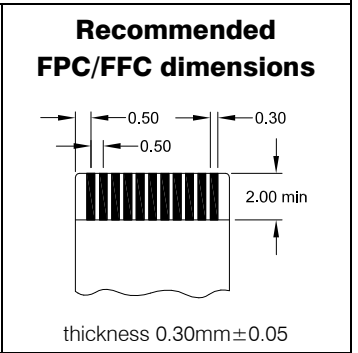
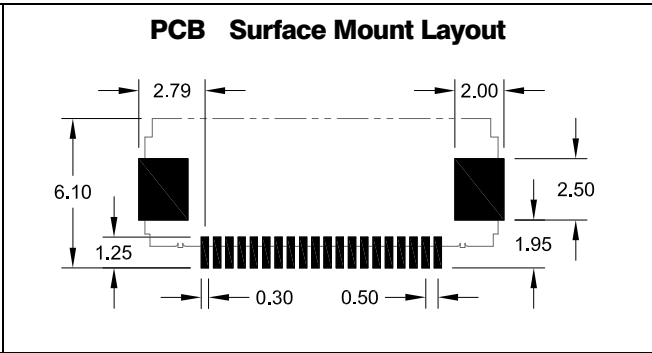
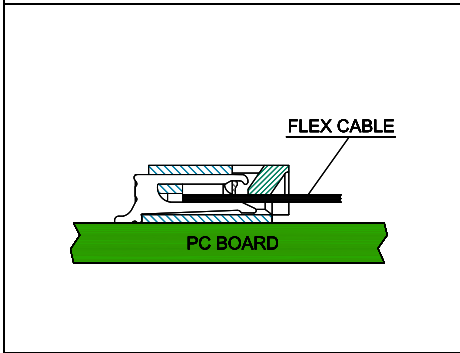
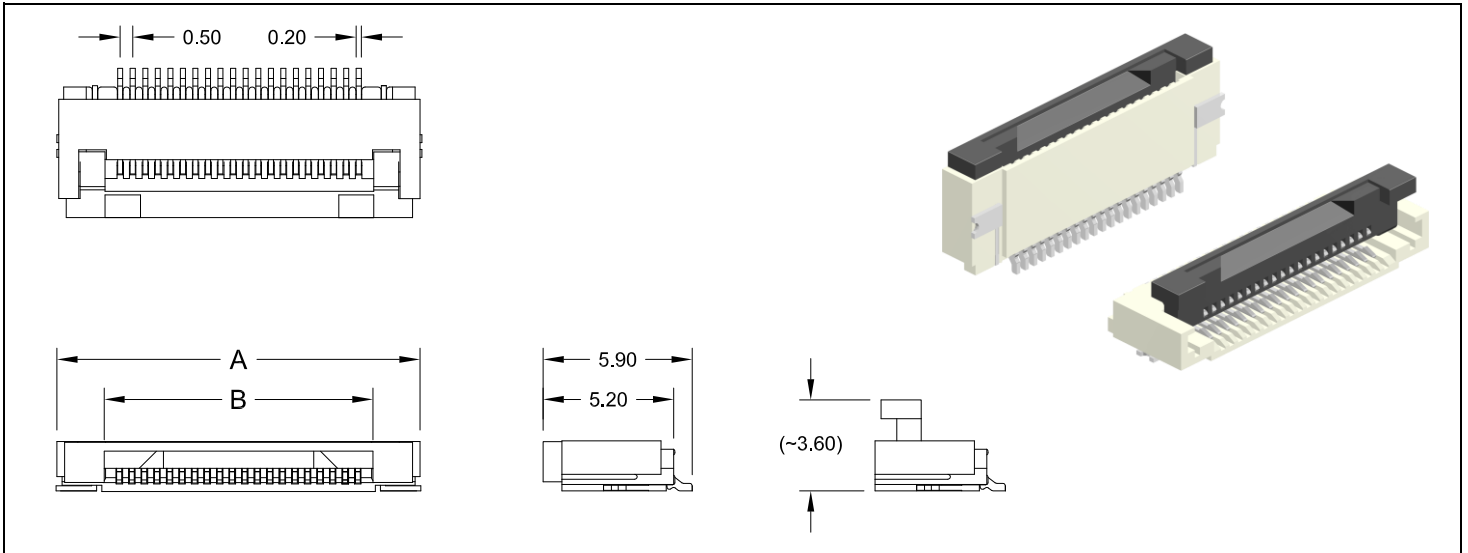

Specifications

Current rating	0.5 A max.	Operating temperature	- 20°C to +85°C
Insulation resistance	500 MΩ min.	Processing temperature	+250°C +0/-5°C for 3sec.
Contact resistance	20 mΩ max.	Contact material	Phosphor Bronze (RoHS compliant)
Withstanding voltage	200 V AC	Contact plating	Tin (leadfree)
		Insulator material	LCP (Natural) UL 94 V-0 (RoHS compliant)
		Actuator material	LCP (Black) UL 94 V-0 (RoHS compliant)

Dimensions (mm)

Contacts	DIM "A"	DIM "B"	Contacts	DIM "A"	DIM "B"	Contacts	DIM "A"	DIM "B"	Contacts	DIM "A"	DIM "B"
006	7.40	3.60	020	14.40	10.60	034	21.40	17.60	048	28.40	24.60
007	7.90	4.10	021	14.90	11.10	035	21.90	18.10	049	28.90	25.10
008	8.40	4.60	022	15.40	11.60	036	22.40	18.60	050	29.40	25.60
009	8.90	5.10	023	15.90	12.10	037	22.90	19.10	051	29.90	26.10
010	9.40	5.60	024	16.40	12.60	038	23.40	19.60	052	30.40	26.60
011	9.90	6.10	025	16.90	13.10	039	23.90	20.10	053	30.90	27.10
012	10.40	6.60	026	17.40	13.60	040	24.40	20.60	054	31.40	27.60
013	10.90	7.10	027	17.90	14.10	041	24.90	21.10	055	31.90	28.10
014	11.40	7.60	028	18.40	14.60	042	25.40	21.60	056	32.40	28.60
015	11.90	8.10	029	18.90	15.10	043	25.90	22.10	057	32.90	29.10
016	12.40	8.60	030	19.40	15.60	044	26.40	22.60	058	33.40	29.60
017	12.90	9.10	031	19.90	16.10	045	26.90	23.10	059	33.90	30.10
018	13.40	9.60	032	20.40	16.60	046	27.40	23.60	060	34.40	30.60
019	13.90	10.10	033	20.90	17.10	047	27.90	24.10			

How to order

FCZ - xxx - H058 - 99 /X

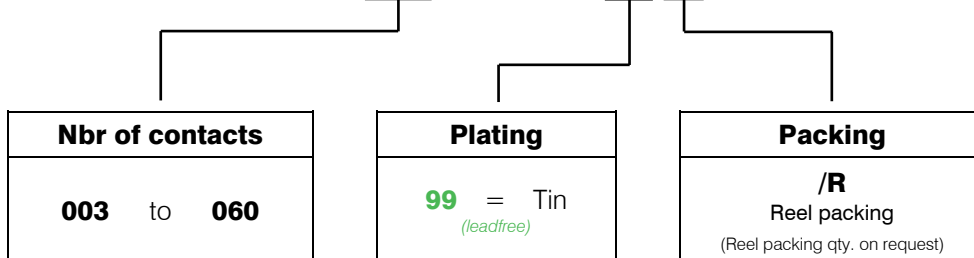



Standard:
Connector with PickUp Tape and Reel packing

PCB Surface Mount Layout

Recommended FPC/FFC dimensions

thickness 0.30mm±0.05

Please ask your sales office for details on reel dimension.

SPECIFICATIONS			
Current rating	0.5 A max.	Operating temperature	- 20°C to +85°C
Insulation resistance	500 MΩ min.	Processing temperature	+250°C +0/-5°C for 3sec.
Contact resistance	30 mΩ max.	Contact material <i>(RoHS compliant)</i>	Phosphor Bronze
Withstanding voltage	500 V AC	Contact plating	Tin <i>(leadfree)</i>
		Insulator material <i>(RoHS compliant)</i>	LCP (beige) UL 94 V-0
		Actuator material <i>(RoHS compliant)</i>	PPS (black) UL 94 V-0

Dimensions (mm)											
Contacts	DIM "A"	DIM "B"	Contacts	DIM "A"	DIM "B"	Contacts	DIM "A"	DIM "B"	Contacts	DIM "A"	DIM "B"
002	3.06	6.90	007	8.06	11.90	012	13.06	16.90	017	18.06	21.90
003	4.06	7.90	008	9.06	10.90	013	14.06	17.90	018	19.06	22.90
004	5.06	8.90	009	10.06	13.90	014	15.06	18.90	019	20.06	23.90
005	6.06	9.90	010	11.06	14.90	015	16.06	19.90			
006	7.06	10.90	011	12.06	15.90	016	17.06	20.90			

How to order

FCZ - xxx - VZ100 - 99 / XX

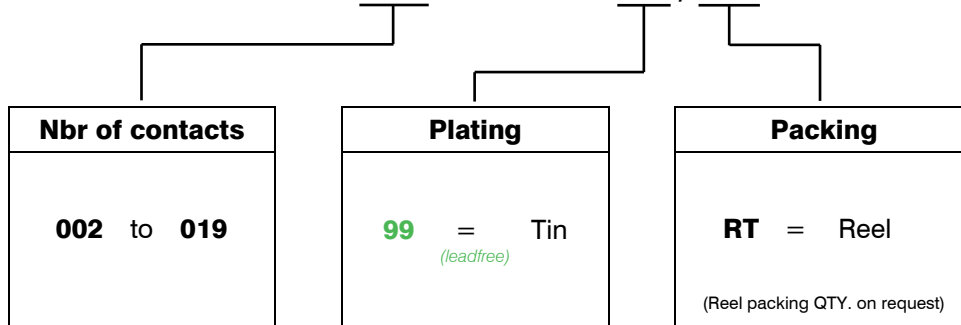

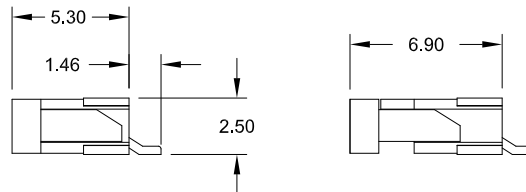
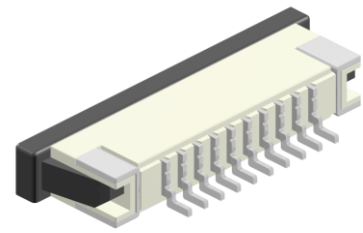
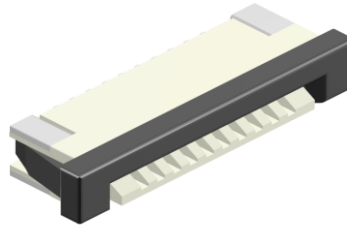
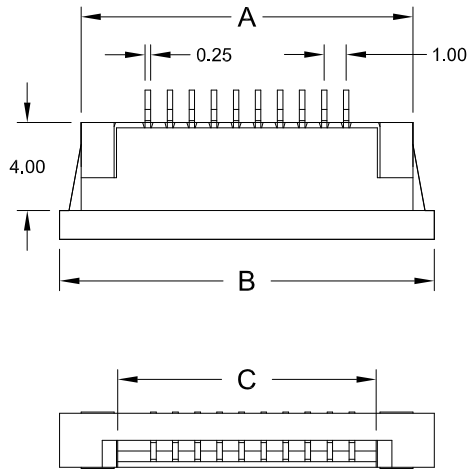

upper contact Style 102

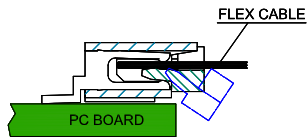

lower contact Style 103

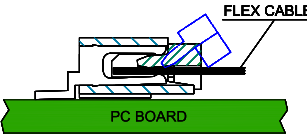

PCB Surface Mount Layout

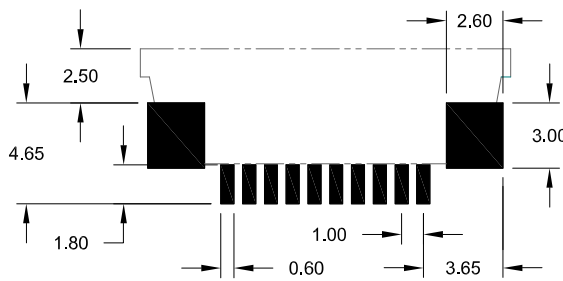

Recommended FPC/FFC dimensions

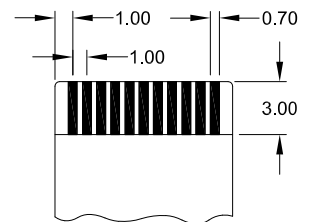

thickness 0.30mm±0.05

SPECIFICATIONS

Current rating	0.5 A max.	Operating temperature	- 20°C to +85°C
Insulation resistance	500 MΩ min.	Processing temperature	+250°C +0/-5°C for 3sec.
Contact resistance	30 mΩ max.	Contact material	Phosphor Bronze (RoHS compliant)
Withstanding voltage	500 V AC	Contact plating	Tin (leadfree)
		Insulator material	LCP (nature) UL 94 V-0 (RoHS compliant)
		Actuator material	LCP (black) UL 94 V-0 (RoHS compliant)

Dimensions (mm)

Contacts	DIM "A"	DIM "B"	DIM "C"	Contacts	DIM "A"	DIM "B"	DIM "C"	Contacts	DIM "A"	DIM "B"	DIM "C"
004	9.05	11.00	5.10	013	18.05	20.00	14.10	022	27.05	29.00	23.10
005	10.05	12.00	6.10	014	19.05	21.00	15.10	023	28.05	30.00	24.10
006	11.05	13.00	7.10	015	20.05	22.00	16.10	024	29.05	31.00	25.10
007	12.05	14.00	8.10	016	21.05	23.00	17.10	025	30.05	32.00	26.10
008	13.05	15.00	9.10	017	22.05	24.00	18.10	026	31.05	33.00	27.10
009	14.05	16.00	10.10	018	23.05	25.00	19.10	027	32.05	34.00	28.10
010	15.05	17.00	11.10	019	24.05	26.00	20.10	028	33.05	35.00	29.10
011	16.05	18.00	12.10	020	25.05	27.00	21.10	029	34.05	36.00	20.10
012	17.05	19.00	13.10	021	26.05	28.00	22.10	030	35.05	37.00	31.10

How to order

FCZ - xxx - H xxx - 99 /R

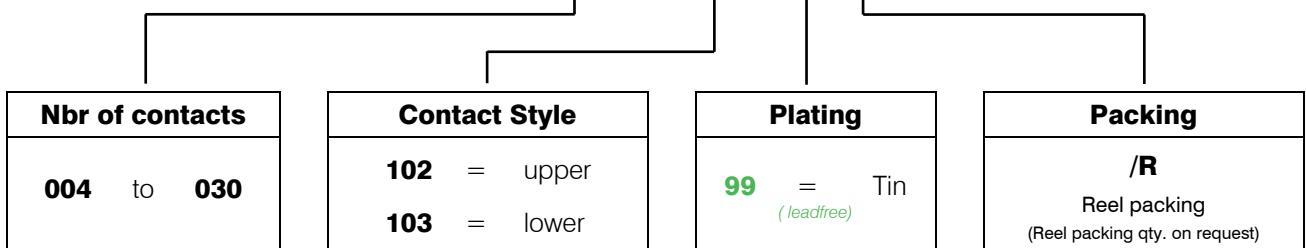

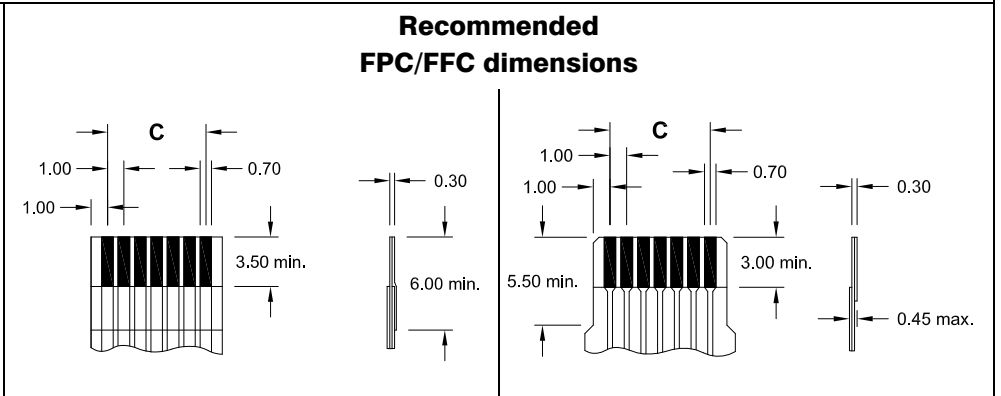
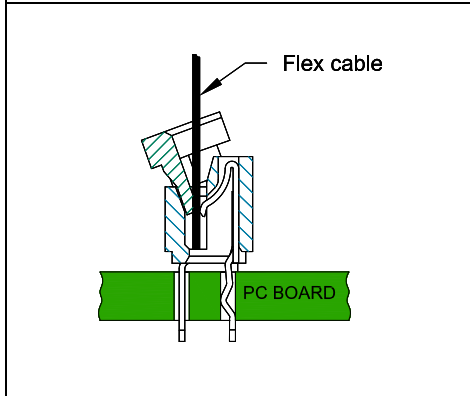
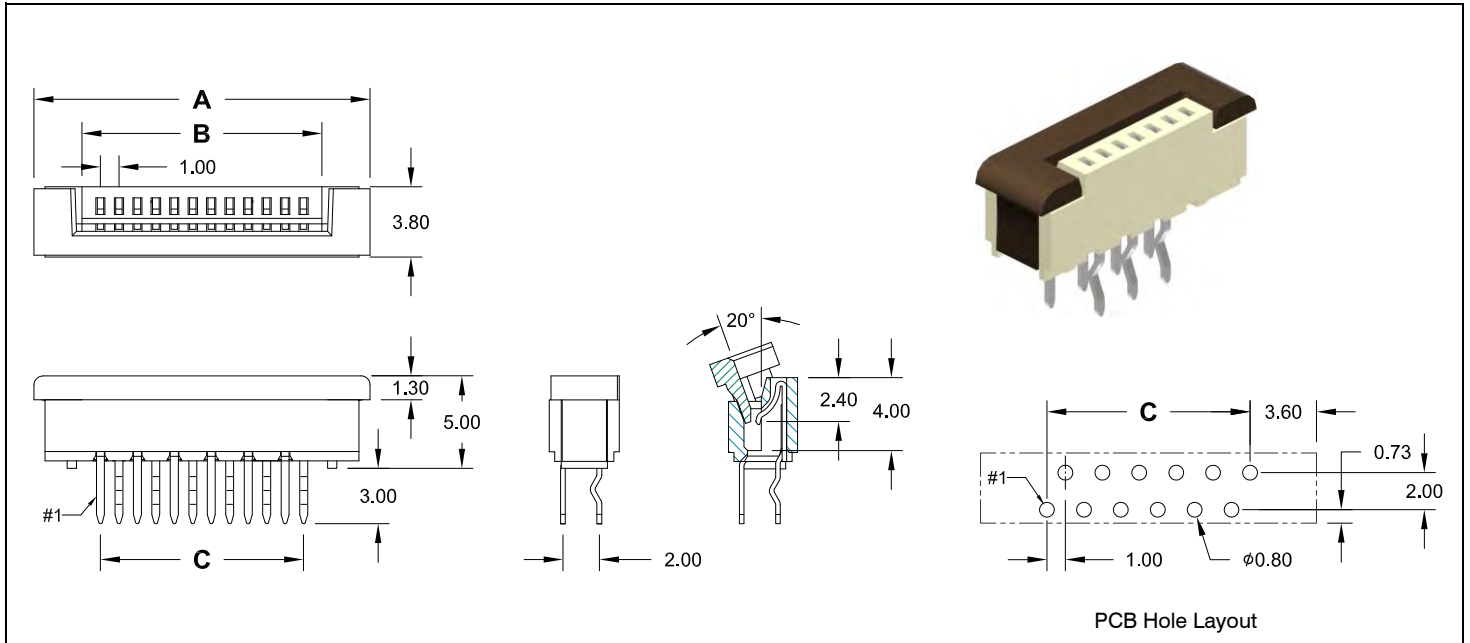

Specifications

Current rating	0.5 A max.	Operating temperature	-20°C to +85°C
Insulation resistance	500 MΩ min.	Contact material	(RoHS compliant) Phosphor Bronze
Contact resistance	30 mΩ max.	Contact plating	Tin (leadfree)
Withstanding voltage	500 V AC	Insulator material	(RoHS compliant) PA6T (natural) UL 94 V-0
		Actuator material	(RoHS compliant) PA6T (brown) UL 94 V-0

Dimensions (mm)

Contacts	DIM "A"	DIM "B"	DIM "C"	Contacts	DIM "A"	DIM "B"	DIM "C"	Contacts	DIM "A"	DIM "B"	DIM "C"	Contacts	DIM "A"	DIM "B"	DIM "C"
004	10.20	5.10	3.00	012	18.20	13.10	11.00	020	26.20	21.10	19.00	028	34.20	29.10	27.00
005	11.20	6.10	4.00	013	19.20	14.10	12.00	021	27.20	22.10	20.00	029	35.20	30.10	28.00
006	12.20	7.10	5.00	014	20.20	15.10	13.00	022	28.20	23.10	21.00	030	36.20	31.10	29.00
007	13.20	8.10	6.00	015	21.20	16.10	14.00	023	29.20	24.10	22.00	031	37.20	32.10	30.00
008	14.20	9.10	7.00	016	22.20	17.10	15.00	024	30.20	25.10	23.00	032	38.20	33.10	31.00
009	15.20	10.10	8.00	017	23.20	18.10	16.00	025	31.20	26.10	24.00				
010	16.20	11.10	9.00	018	24.20	19.10	17.00	026	32.20	27.10	25.00				
011	17.20	12.10	10.00	019	25.20	20.10	18.00	027	33.20	28.10	26.00				

How to order

FCZ - xxx - SL100 - 99

Nbr of contacts

004	to	032
-----	----	-----

Plating

99	=	Tin
		(leadfree)

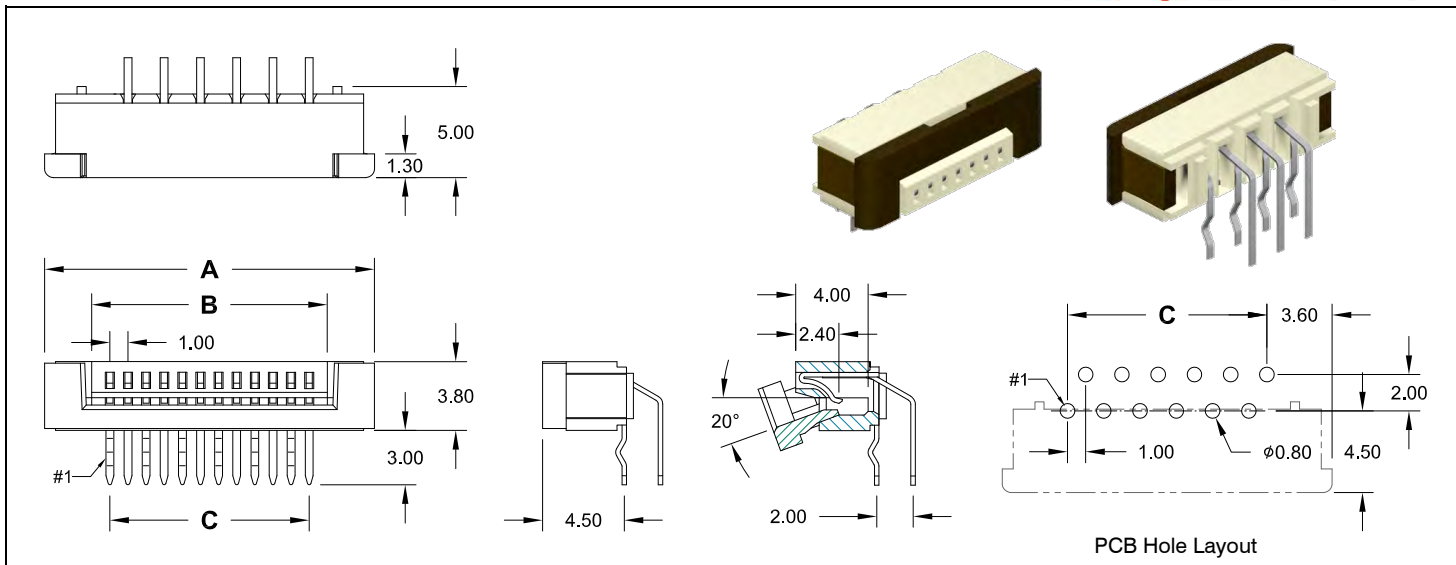

upper contact Style 100

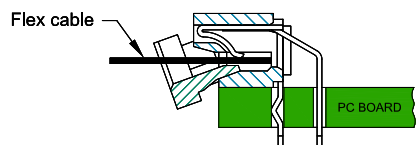

lower contact Style 101

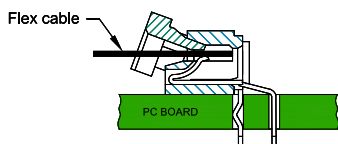

Recommended FPC/FFC dimensions

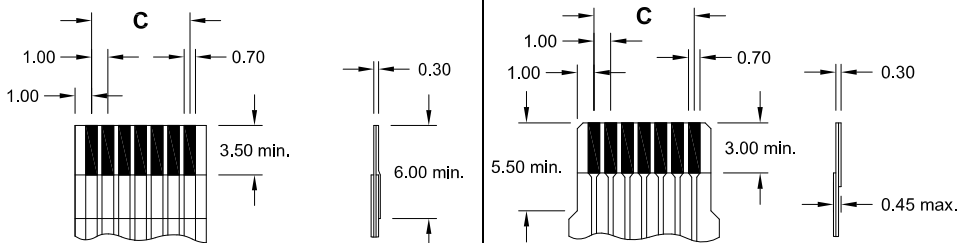

Specifications

Current rating	0.5 A max.	Operating temperature	-20°C to +85°C
Insulation resistance	500 MΩ min.	Contact material	Phosphor Bronze (RoHS compliant)
Contact resistance	30 mΩ max.	Contact plating	Tin (leadfree)
Withstanding voltage	500 V AC	Insulator material	PA6T (nature) UL 94 V-0 (RoHS compliant)
		Actuator material	PA6T (brown) UL 94 V-0 (RoHS compliant)

Dimensions (mm)

Contacts	DIM "A"	DIM "B"	DIM "C"	Contacts	DIM "A"	DIM "B"	DIM "C"	Contacts	DIM "A"	DIM "B"	DIM "C"	Contacts	DIM "A"	DIM "B"	DIM "C"
004	10.20	5.10	3.00	012	18.20	13.10	11.00	020	26.20	21.10	19.00	028	34.20	29.10	27.00
005	11.20	6.10	4.00	013	19.20	14.10	12.00	021	27.20	22.10	20.00	029	35.20	30.10	28.00
006	12.20	7.10	5.00	014	20.20	15.10	13.00	022	28.20	23.10	21.00	030	36.20	31.10	29.00
007	13.20	8.10	6.00	015	21.20	16.10	14.00	023	29.20	24.10	22.00	031	37.20	32.10	30.00
008	14.20	9.10	7.00	016	22.20	17.10	15.00	024	30.20	25.10	23.00	032	38.20	33.10	31.00
009	15.20	10.10	8.00	017	23.20	18.10	16.00	025	31.20	26.10	24.00				
010	16.20	11.10	9.00	018	24.20	19.10	17.00	026	32.20	27.10	25.00				
011	17.20	12.10	10.00	019	25.20	20.10	18.00	027	33.20	28.10	26.00				

How to order

FCZ - xxx - RL xxx - 99

Nbr of contacts
004 to 032

Contact Style
100 = upper
101 = lower

Plating
99 = Tin (leadfree)

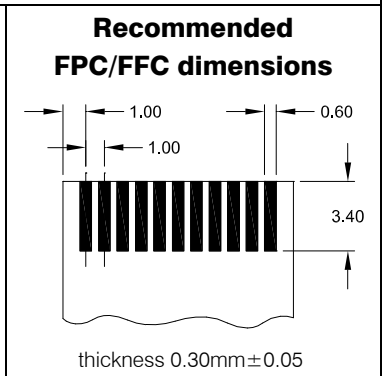
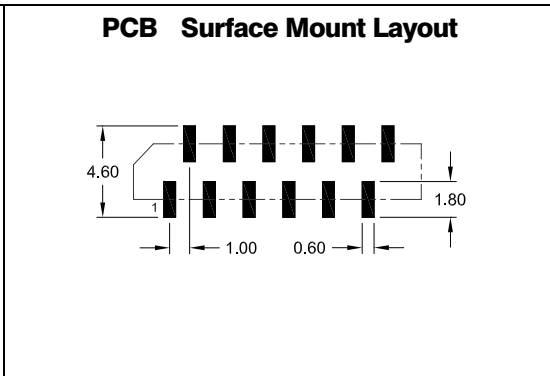
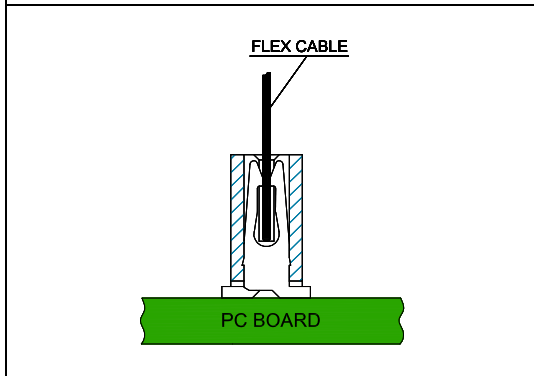
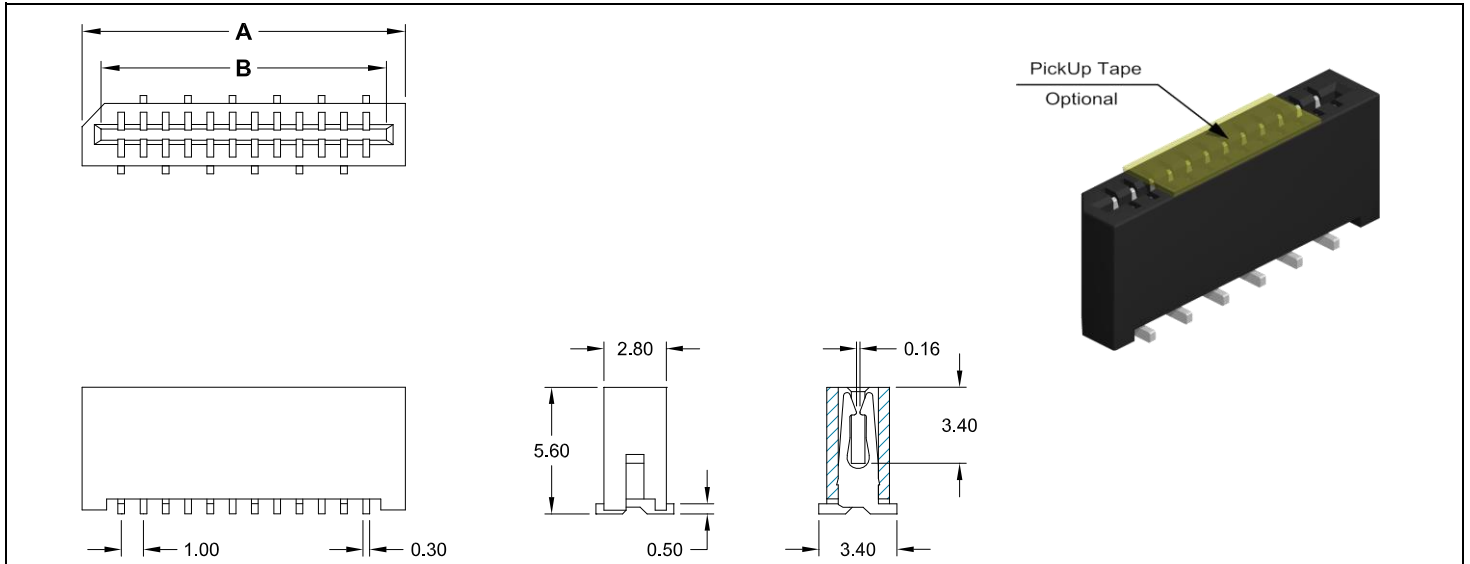

Specifications

Current rating	0.5 A max.	Operating temperature	- 20°C to +85°C
Insulation resistance	500 MΩ min.	Processing temperature	+250°C +0/-5°C for 3sec.
Contact resistance	30 mΩ max.	Contact material	Phosphor Bronze (RoHS compliant)
Withstanding voltage	500 V AC	Contact plating	Tin (leadfree)
		Insulator material	PA9T (black) UL 94 V-0 (RoHS compliant)

Dimensions (mm)

Contacts	DIM "A"	DIM "B"	Contacts	DIM "A"	DIM "B"	Contacts	DIM "A"	DIM "B"	Contacts	DIM "A"	DIM "B"
003	6.00	4.10	012	15.00	13.10	021	24.00	22.10	030	33.00	31.10
004	7.00	5.10	013	16.00	14.10	022	25.00	23.10			
005	8.00	6.10	014	17.00	15.10	023	26.00	24.10			
006	9.00	7.10	015	18.00	16.10	024	27.00	25.10			
007	10.00	8.10	016	19.00	17.10	025	28.00	26.10			
008	11.00	9.10	017	20.00	18.10	026	29.00	27.10			
009	12.00	10.10	018	21.00	19.10	027	30.00	28.10			
010	13.00	11.10	019	22.00	20.10	028	31.00	29.10			
011	14.00	12.10	020	23.00	21.10	029	32.00	30.10			

How to order

FCL - xxx - V100 - 99 /XX

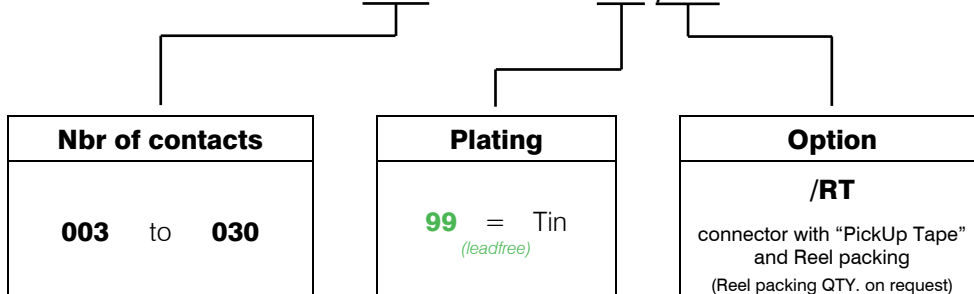

FPC/FFC Connector **LIF Type**
 - SMT - 1.00mm pitch horizontal

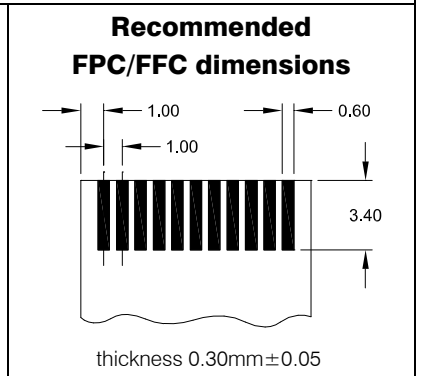
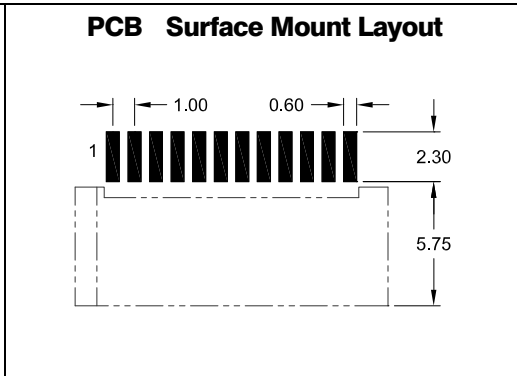
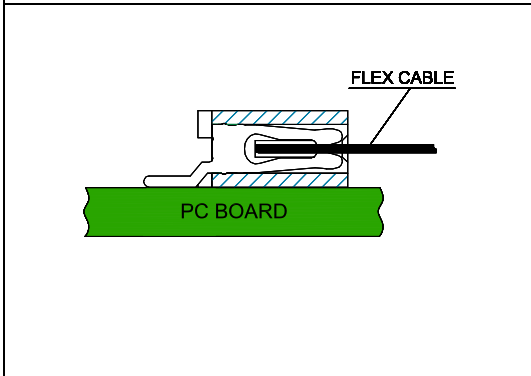
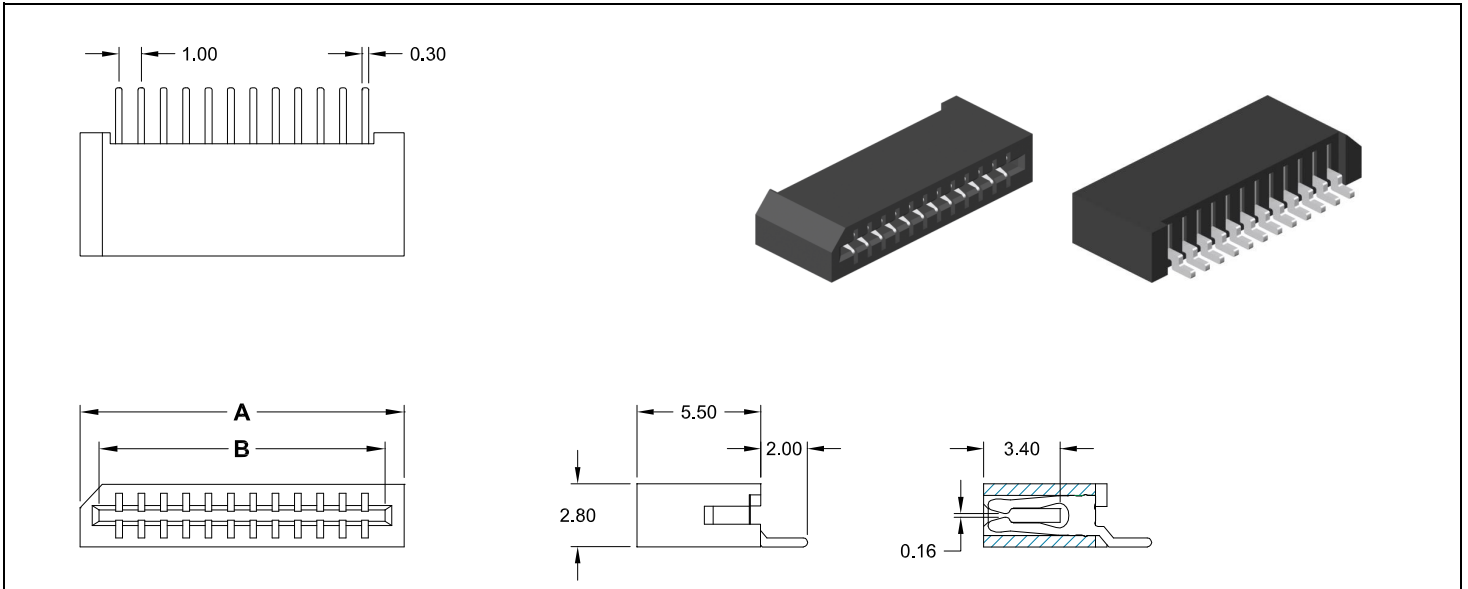

Specifications

Current rating	0.5 A max.	Operating temperature	- 20°C to +85°C
Insulation resistance	500 MΩ min.	Processing temperature	+250°C +0/-5°C for 3sec.
Contact resistance	30 mΩ max.	Contact material	Phosphor Bronze (RoHS compliant)
Withstanding voltage	500 V AC	Contact plating	Tin (leadfree)
		Insulator material	PA9T (black) UL 94 V-0 (RoHS compliant)

Dimensions (mm)

Contacts	DIM "A"	DIM "B"	Contacts	DIM "A"	DIM "B"	Contacts	DIM "A"	DIM "B"	Contacts	DIM "A"	DIM "B"
003	6.00	4.10	012	15.00	13.10	021	24.00	22.10	030	33.00	31.10
004	7.00	5.10	013	16.00	14.10	022	25.00	23.10			
005	8.00	6.10	014	17.00	15.10	023	26.00	24.10			
006	9.00	7.10	015	18.00	16.10	024	27.00	25.10			
007	10.00	8.10	016	19.00	17.10	025	28.00	26.10			
008	11.00	9.10	017	20.00	18.10	026	29.00	27.10			
009	12.00	10.10	018	21.00	19.10	027	30.00	28.10			
010	13.00	11.10	019	22.00	20.10	028	31.00	29.10			
011	14.00	12.10	020	23.00	21.10	029	32.00	30.10			

How to order

FCL - xxx - H100 - 99 /X

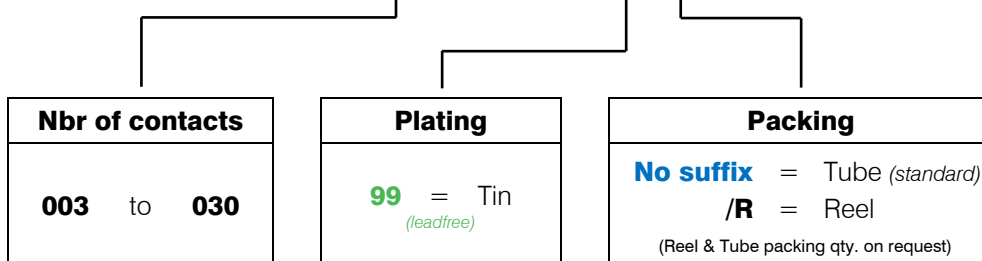

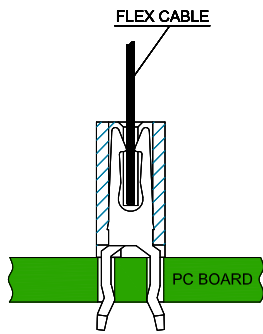
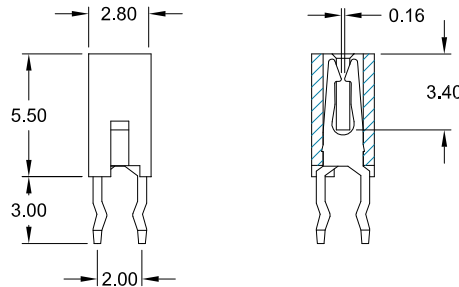
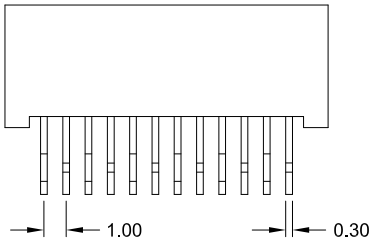
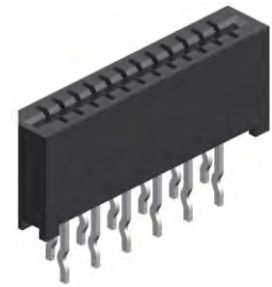
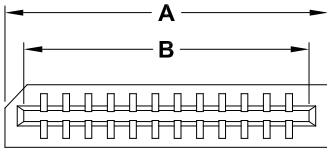

PCB Hole Layout

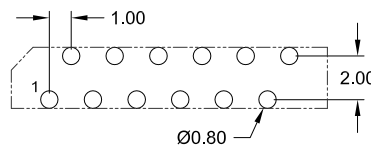

Recommended FPC/FFC dimensions

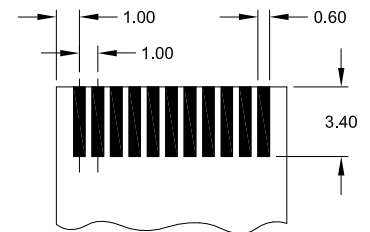

thickness 0.30mm±0.05

Specifications

Current rating	0.5 A max.	Operating temperature	- 20°C to +85°C
Insulation resistance	500 MΩ min.	Contact material	Phosphor Bronze (RoHS compliant)
Contact resistance	30 mΩ max.	Contact plating	Tin (leadfree)
Withstanding voltage	500 V AC	Insulator material	PA9T (black) UL 94 V-0 (RoHS compliant)

Dimensions (mm)

Contacts	DIM "A"	DIM "B"	Contacts	DIM "A"	DIM "B"	Contacts	DIM "A"	DIM "B"	Contacts	DIM "A"	DIM "B"
003	6.00	4.10	012	15.00	13.10	021	24.00	22.10	030	33.00	31.10
004	7.00	5.10	013	16.00	14.10	022	25.00	23.10	031	34.00	32.10
005	8.00	6.10	014	17.00	15.10	023	26.00	24.10	032	35.00	33.10
006	9.00	7.10	015	18.00	16.10	024	27.00	25.10			
007	10.00	8.10	016	19.00	17.10	025	28.00	26.10			
008	11.00	9.10	017	20.00	18.10	026	29.00	27.10			
009	12.00	10.10	018	21.00	19.10	027	30.00	28.10			
010	13.00	11.10	019	22.00	20.10	028	31.00	29.10			
011	14.00	12.10	020	23.00	21.10	029	32.00	30.10			

How to order

FCL - xxx - S100 - 99

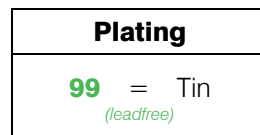

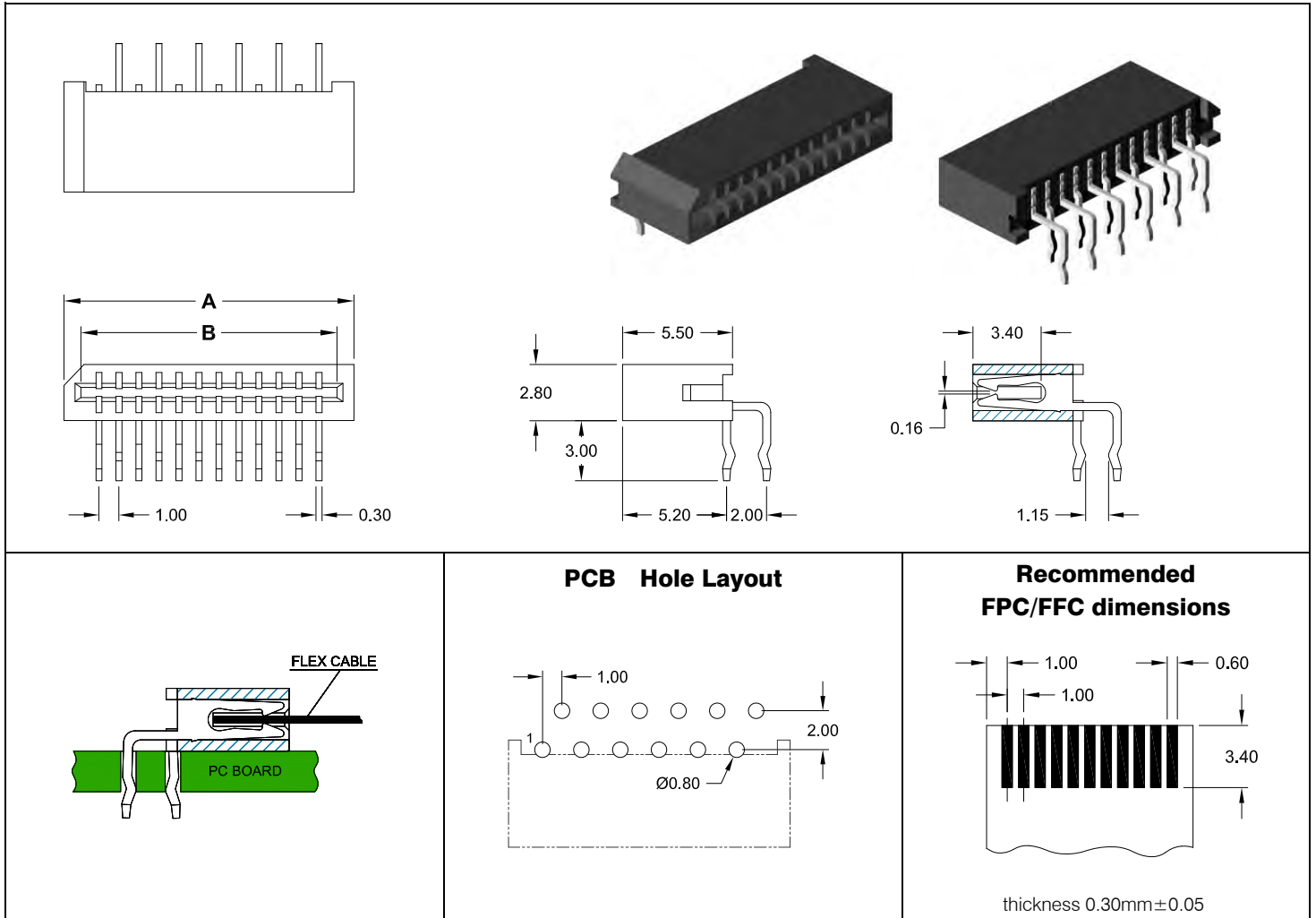

Specifications			
Current rating	0.5 A max.	Operating temperature	- 20°C to +85°C
Insulation resistance	500 MΩ min.	Contact material	Phosphor Bronze (RoHS compliant)
Contact resistance	30 mΩ max.	Contact plating	Tin (leadfree)
Withstanding voltage	500 V AC	Insulator material	PA9T (black) UL 94 V-0 (RoHS compliant)

Dimensions (mm)											
Contacts	DIM "A"	DIM "B"	Contacts	DIM "A"	DIM "B"	Contacts	DIM "A"	DIM "B"	Contacts	DIM "A"	DIM "B"
003	6.00	4.10	012	15.00	13.10	021	24.00	22.10	030	33.00	31.10
004	7.00	5.10	013	16.00	14.10	022	25.00	23.10			
005	8.00	6.10	014	17.00	15.10	023	26.00	24.10			
006	9.00	7.10	015	18.00	16.10	024	27.00	25.10			
007	10.00	8.10	016	19.00	17.10	025	28.00	26.10			
008	11.00	9.10	017	20.00	18.10	026	29.00	27.10			
009	12.00	10.10	018	21.00	19.10	027	30.00	28.10			
010	13.00	11.10	019	22.00	20.10	028	31.00	29.10			
011	14.00	12.10	020	23.00	21.10	029	32.00	30.10			

How to order

FCL - xxx - R100 - 99

Nbr of contacts
003 to 030

Plating
99 = Tin (leadfree)

FPC/FFC Connector LIF Type

- SMT - 1.25mm pitch horizontal

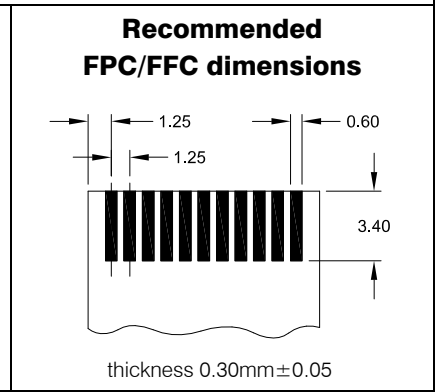
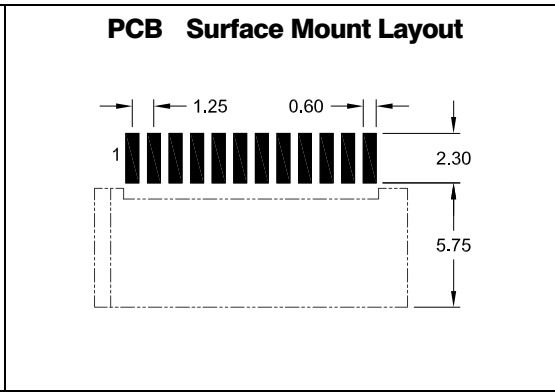
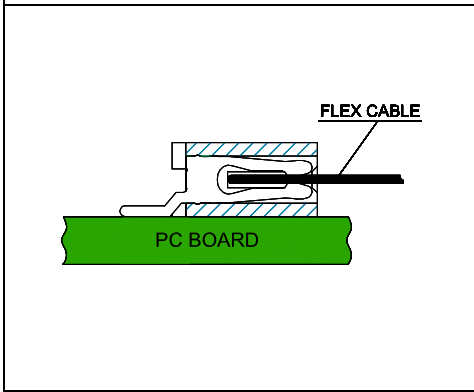
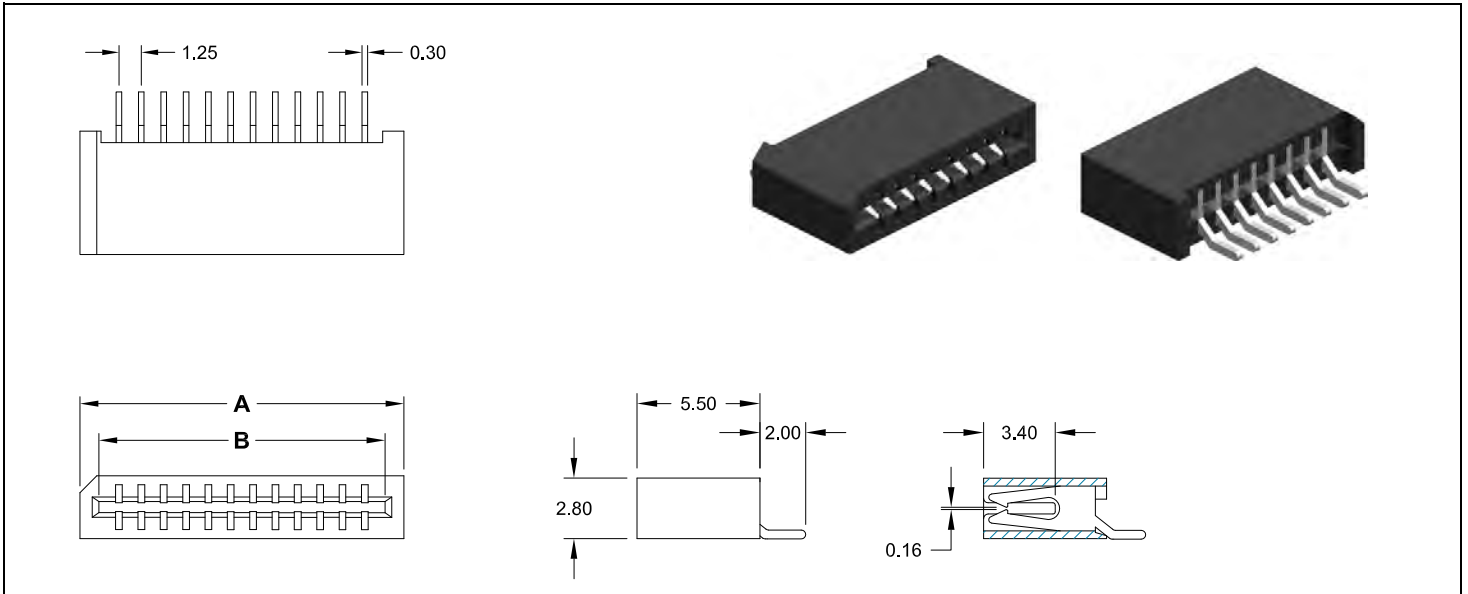

Specifications

Current rating	0.5 A max.	Operating temperature	- 20°C to +85°C
Insulation resistance	500 MΩ min.	Processing temperature	+250°C +0/-5°C for 3sec.
Contact resistance	30 mΩ max.	Contact material	Phosphor Bronze (RoHS compliant)
Withstanding voltage	500 V AC	Contact plating	Tin (leadfree)
		Insulator material	PA9T (black) UL 94 V-0 (RoHS compliant)

Dimensions (mm)

Contacts	DIM "A"	DIM "B"	Contacts	DIM "A"	DIM "B"	Contacts	DIM "A"	DIM "B"	Contacts	DIM "A"	DIM "B"
003	7.15	5.10	012	18.40	16.35	021	29.65	27.60	030	40.90	38.85
004	8.40	6.35	013	19.65	17.60	022	30.90	28.85			
005	9.65	7.60	014	20.90	18.85	023	32.15	30.10			
006	10.90	8.85	015	22.15	20.10	024	33.40	31.35			
007	12.15	10.10	016	23.40	21.35	025	34.65	32.60			
008	13.40	11.35	017	24.65	22.60	026	35.90	33.85			
009	14.65	12.60	018	25.90	23.85	027	37.15	35.10			
010	15.90	13.85	019	27.15	25.10	028	38.40	36.35			
011	17.50	15.10	020	28.40	26.35	029	39.65	37.60			

How to order

FCL - xxx - H125 - 99 /X

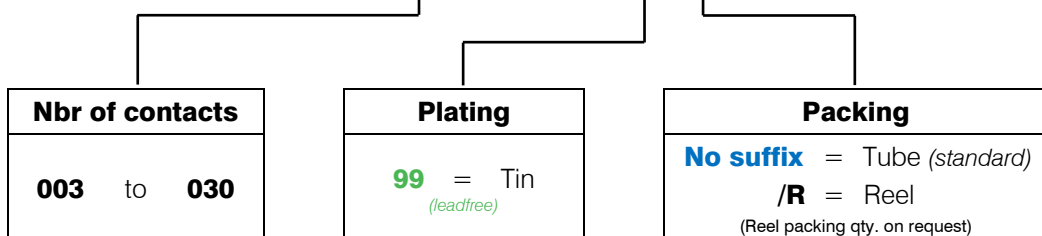

FPC/FFC Connector **LIF Type**
 - THT - 1.25mm pitch vertical

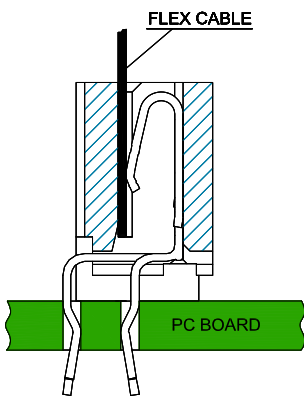
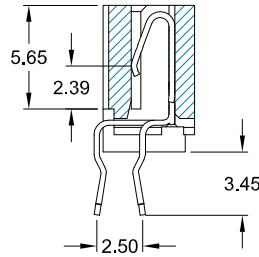
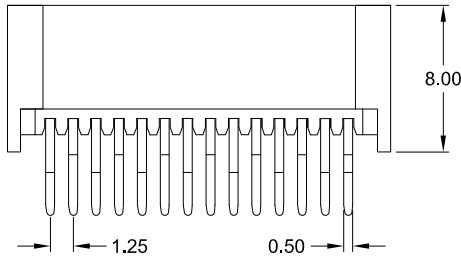
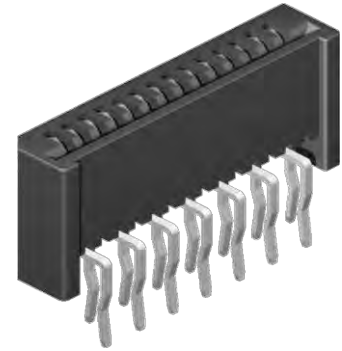
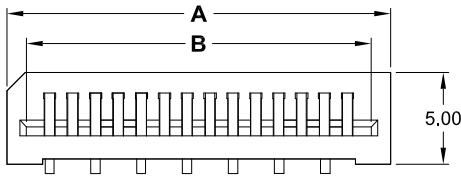

PCB Hole Layout

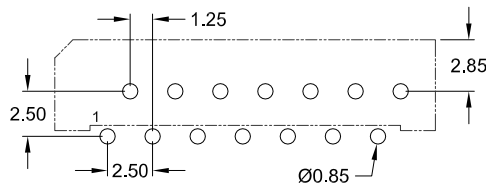

Recommended FPC/FFC dimensions

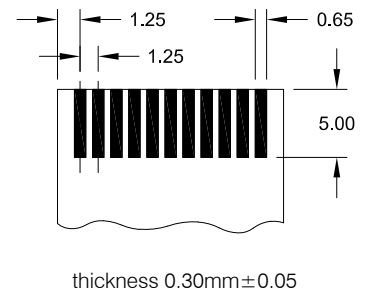

Specifications

Current rating	0.5 A max.	Operating temperature	- 20°C to +85°C
Insulation resistance	500 MΩ min.	Contact material	Phosphor Bronze (RoHS compliant)
Contact resistance	30 mΩ max.	Contact plating	Tin (leadfree)
Withstanding voltage	500 V AC	Insulator material	PA9T (black) UL 94 V-0 (RoHS compliant)

Dimensions (mm)

Contacts	DIM "A"	DIM "B"	Contacts	DIM "A"	DIM "B"	Contacts	DIM "A"	DIM "B"	Contacts	DIM "A"	DIM "B"
004	8.40	6.30	013	19.65	17.55	022	30.90	28.80	031	42.15	40.05
005	9.65	7.55	014	20.90	18.80	023	32.15	30.05	032	43.40	41.30
006	10.90	8.80	015	22.15	20.05	024	33.40	31.30	033	44.65	42.55
007	12.15	10.05	016	23.40	21.30	025	34.65	32.55	034	45.90	43.80
008	13.40	11.30	017	24.65	22.55	026	35.90	33.80	035	47.15	45.05
009	14.65	12.55	018	25.90	23.80	027	37.15	35.05			
010	15.90	13.80	019	27.15	25.05	028	38.40	36.30			
011	17.50	15.05	020	28.40	26.30	029	39.65	37.55			
012	18.40	16.30	021	29.65	27.55	030	40.90	38.80			

How to order

FCL - xxx - S125 - 99

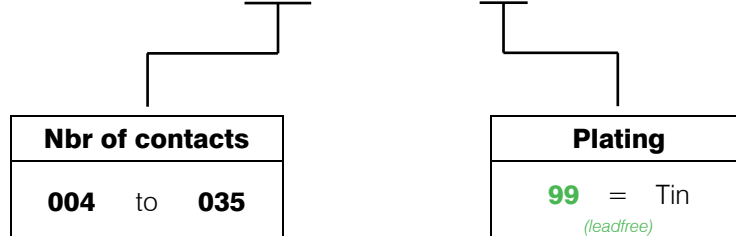

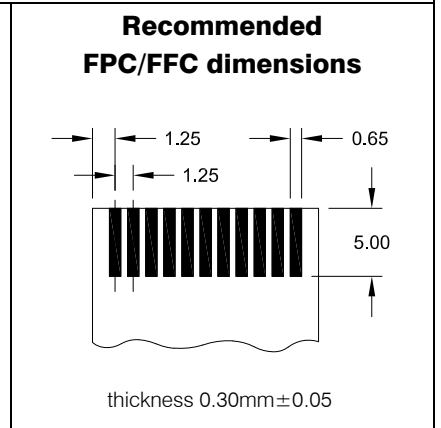
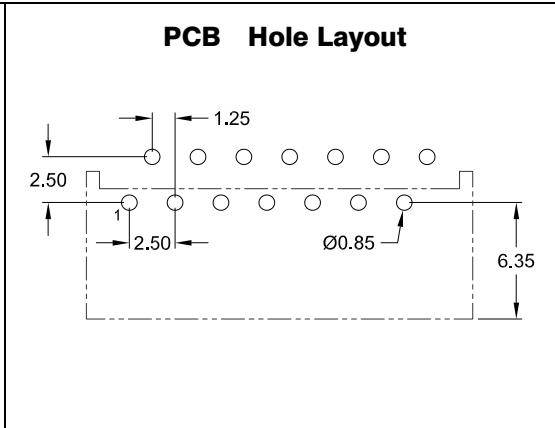
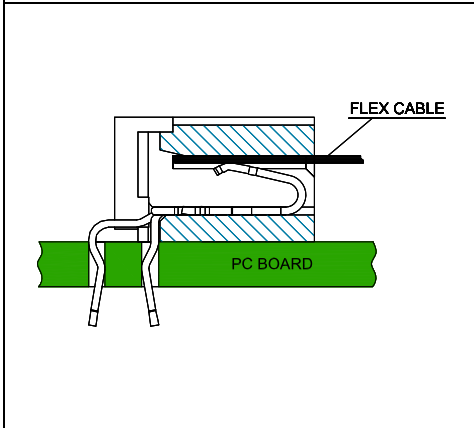
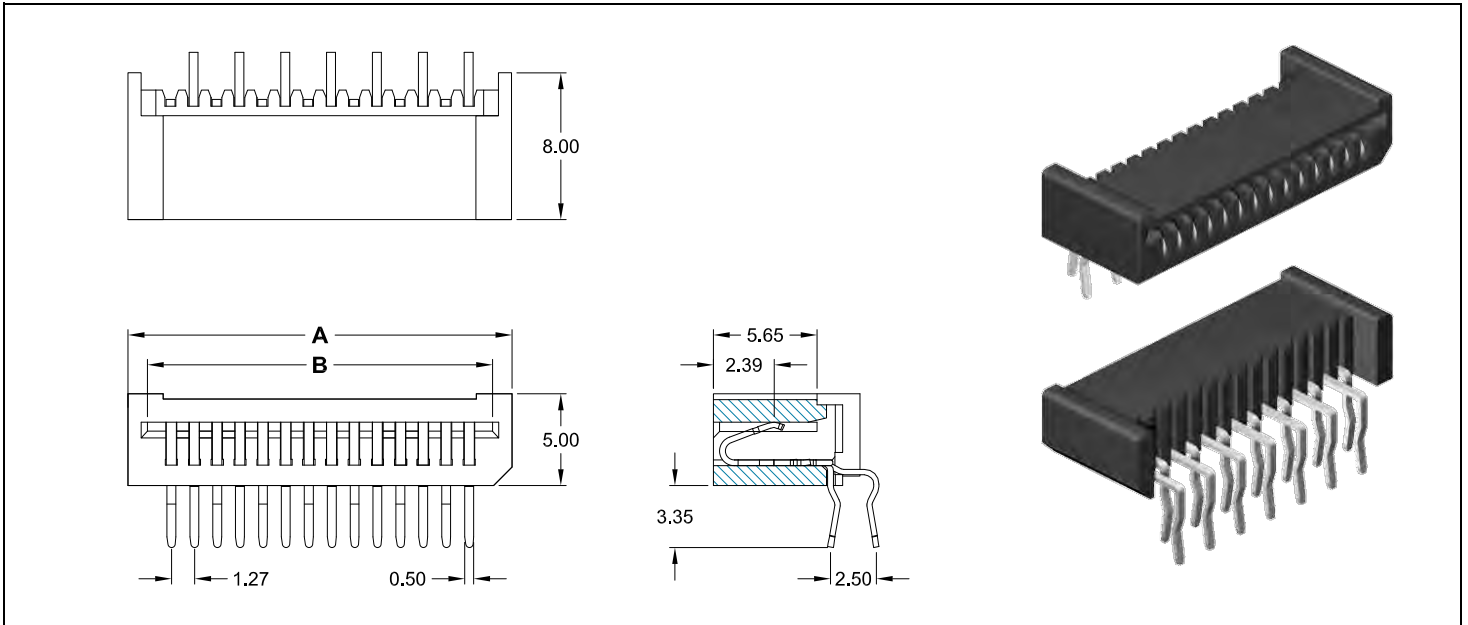

Specifications

Current rating	0.5 A max.	Operating temperature	- 20°C to +85°C
Insulation resistance	500 MΩ min.	Contact material	Phosphor Bronze (RoHS compliant)
Contact resistance	30 mΩ max.	Contact plating	Tin (leadfree)
Withstanding voltage	500 V AC	Insulator material	PA9T (black) UL 94 V-0 (RoHS compliant)

Dimensions (mm)

Contacts	DIM "A"	DIM "B"	Contacts	DIM "A"	DIM "B"	Contacts	DIM "A"	DIM "B"	Contacts	DIM "A"	DIM "B"
004	8.40	6.30	013	19.65	17.55	022	30.90	28.80	031	42.15	40.05
005	9.65	7.55	014	20.90	18.80	023	32.15	30.05	032	43.40	41.30
006	10.90	8.80	015	22.15	20.05	024	33.40	31.30	033	44.65	42.55
007	12.15	10.05	016	23.40	21.30	025	34.65	32.55	034	45.90	43.80
008	13.40	11.30	017	24.65	22.55	026	35.90	33.80	035	47.15	45.05
009	14.65	12.55	018	25.90	23.80	027	37.15	35.05			
010	15.90	13.80	019	27.15	25.05	028	38.40	36.30			
011	17.50	15.05	020	28.40	26.30	029	39.65	37.55			
012	18.40	16.30	021	29.65	27.55	030	40.90	38.80			

How to order

FCL - xxx - R125 - 99

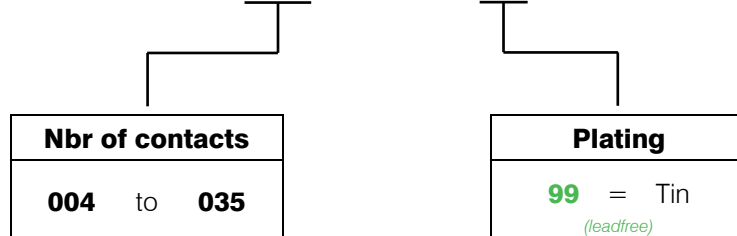

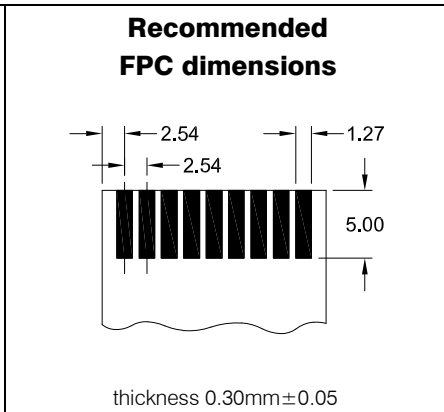
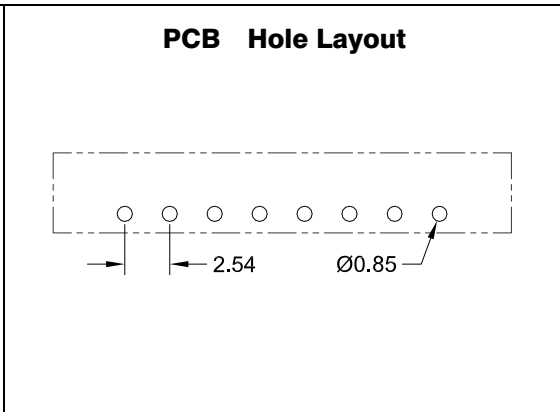
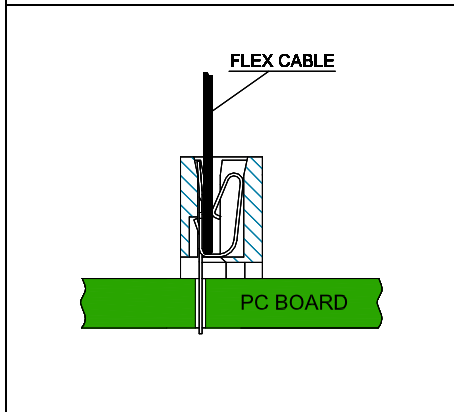
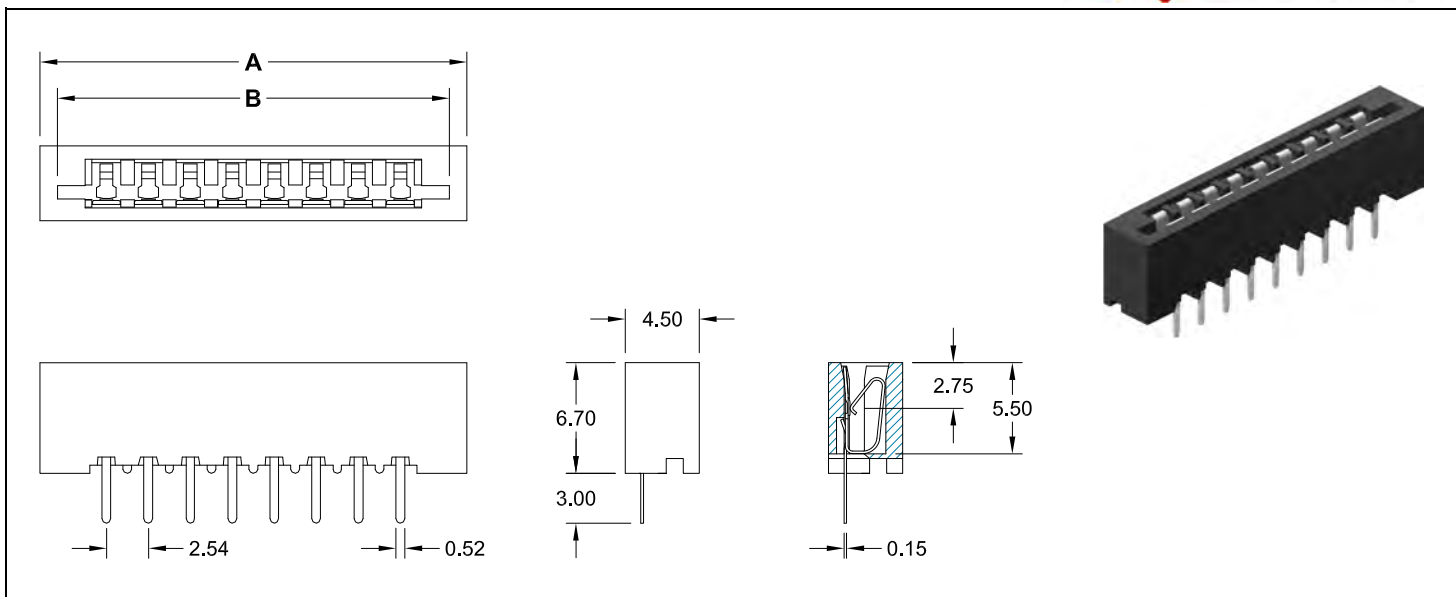

Specifications

Current rating	1.0 A max.	Operating temperature	- 20°C to +85°C
Insulation resistance	1000 MΩ min.	Contact material	Phosphor Bronze (RoHS compliant)
Contact resistance	30 mΩ max.	Contact plating	Tin (leadfree)
Withstanding voltage	500 V AC	Insulator material	PA9T (black) UL 94 V-0 (RoHS compliant)

Dimensions (mm)

Contacts	DIM "A"	DIM "B"	Contacts	DIM "A"	DIM "B"	Contacts	DIM "A"	DIM "B"	Contacts	DIM "A"	DIM "B"
002	10.54	8.43	009	28.32	26.21	016	46.10	43.99	023	63.88	61.77
003	13.08	10.97	010	30.86	28.75	017	48.64	46.53	024	66.42	64.31
004	15.62	13.51	011	33.40	31.29	018	51.18	49.07	025	68.96	66.85
005	18.16	16.05	012	35.94	33.83	019	53.72	51.60	026	71.50	69.39
006	20.70	18.59	013	38.48	36.37	020	56.26	54.15			
007	23.24	21.13	014	41.02	38.91	021	58.80	56.69			
008	25.78	23.67	015	43.56	41.45	022	61.34	59.23			

How to order

FPC - xxx - S254 - 99

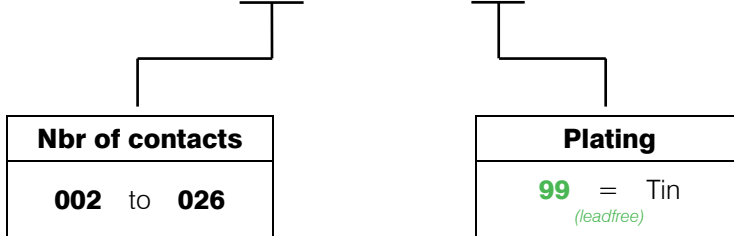

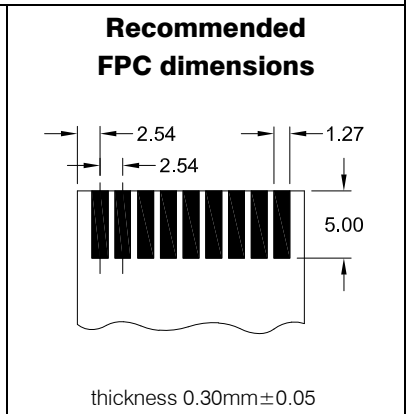
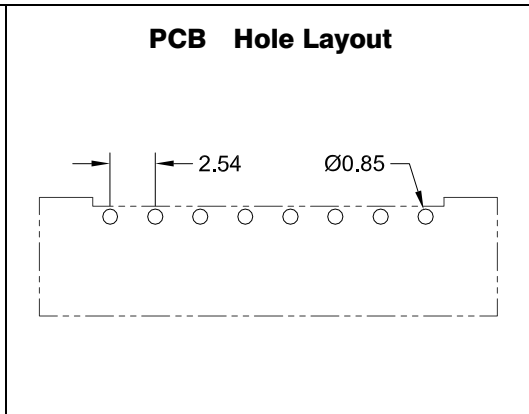
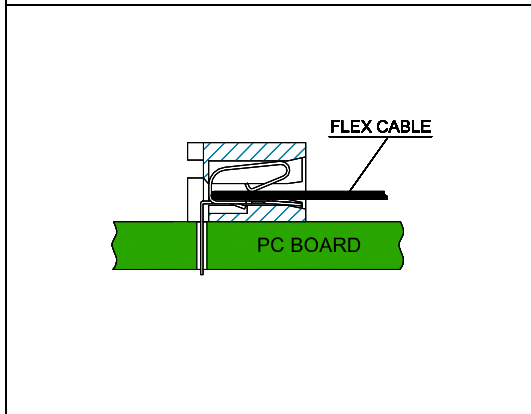
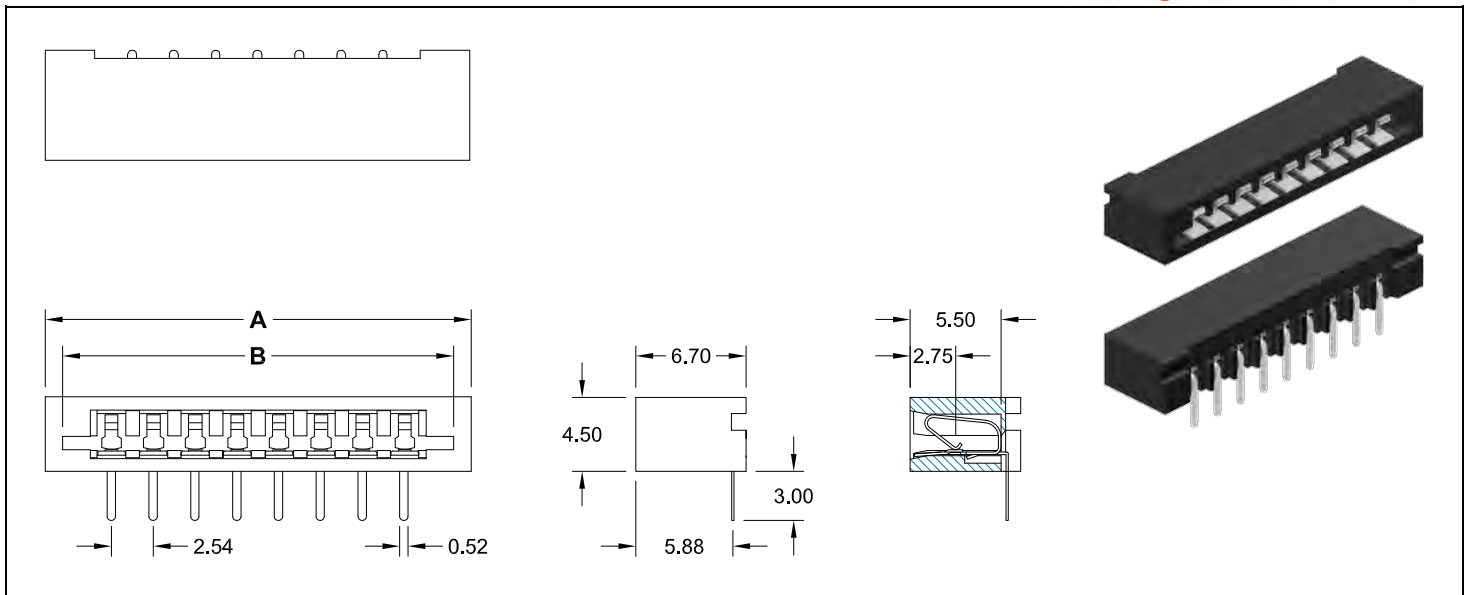

Specifications

Current rating	1.0 A max.	Operating temperature	- 20°C to +85°C
Insulation resistance	1000 MΩ min.	Contact material	Phosphor Bronze (RoHS compliant)
Contact resistance	30 mΩ max.	Contact plating	Tin (leadfree)
Withstanding voltage	500 V AC	Insulator material	PA9T (black) UL 94 V-0 (RoHS compliant)

Dimensions (mm)

Contacts	DIM "A"	DIM "B"	Contacts	DIM "A"	DIM "B"	Contacts	DIM "A"	DIM "B"	Contacts	DIM "A"	DIM "B"
002	10.54	8.43	009	28.32	26.21	016	46.10	43.99	023	63.88	61.77
003	13.08	10.97	010	30.86	28.75	017	48.64	46.53	024	66.42	64.31
004	15.62	13.51	011	33.40	31.29	018	51.18	49.07	025	68.96	66.85
005	18.16	16.05	012	35.94	33.83	019	53.72	51.60	026	71.50	69.39
006	20.70	18.59	013	38.48	36.37	020	56.26	54.15			
007	23.24	21.13	014	41.02	38.91	021	58.80	56.69			
008	25.78	23.67	015	43.56	41.45	022	61.34	59.23			

How to order

FPC - xxx - R254 - 99

Nbr of contacts
002 to 026

Plating
99 = Tin (leadfree)

Flex Cable

0.50mm to 2.54mm pitch

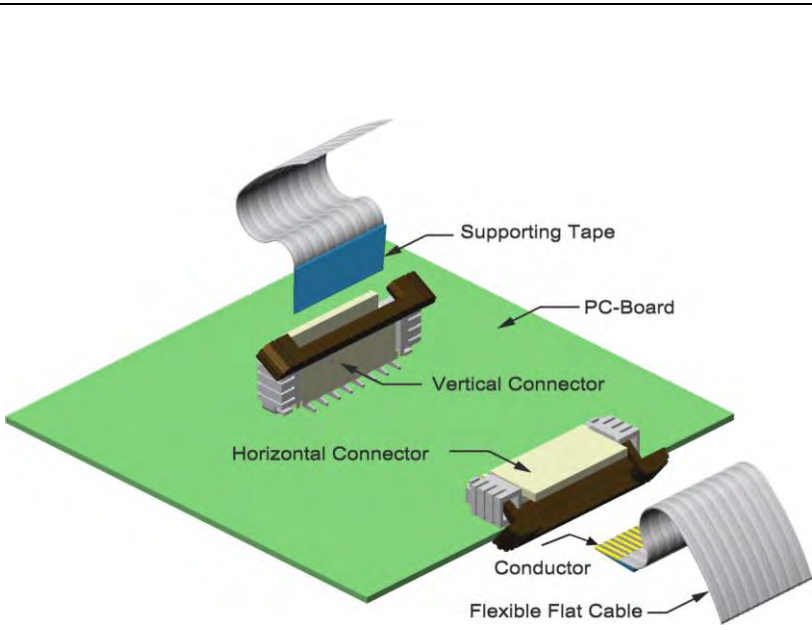

Specifications

Conductor resistance	according to JIS C-C3102 (@ 20°C)	
Insulation resistance (as per MIL-STD-202F Method 302 cond. B)	> 1000MΩ/Meter	
Dielectric strength (as per MIL-STD-202 Method 301)	500V AC / Minute	
Voltage rating	up to 2.54mm pitch:	60V AC
Current rating @20°C	0.50mm pitch:	0.4A
	0.80 & 1.00mm pitch:	1.0A
	1.25mm pitch:	1.5A
	2.54mm pitch:	2.0A
Temperature rating	-40°C to +85°C	
Flame Test	UL Sub, 758 VW-1	
Flexing Test		
A) Bending angle: 180°, R=Cable thickness	≥ 20 cycles	
B) R=10.00mm 70 cycle/Minute @23°C	≥ 100.000 cycles	
Abrasion Test following EN3475-503		
Tool: Ø0.50mm, Weight: 600g, Speed: 60 cycle/Min.	≥ 10.000 cycles	
Insulator	Polyester (white)	
Supporting Tape	Polyester (blue)	
Conductor	flat Copper Wire Tin or Gold plated	
Available UL Style:	20624/20798 (others on request)	

Dimensions

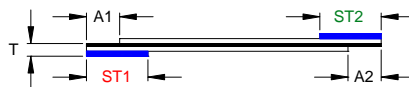
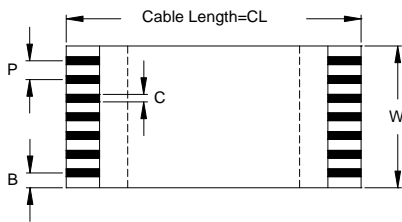

Cable Type

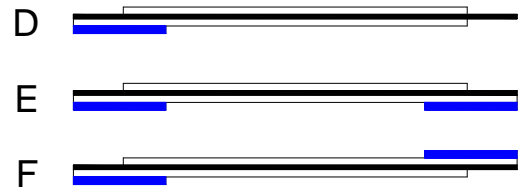

DIM (mm)	"P" (Pitch)	"C"	"B"	"W"	"CL"	"T"	"A1"	"A2"	"ST1" (Supporting Tape)	"ST2" (Supporting Tape)
Range	0.50 - 2.54	0.30 - 0.80	same as "P"	Px(n+1)	20.00 min.	0.30	3.00 - 6.00	3.00 - 6.00	6.00 - 15.00	6.00 - 15.00
Tolerance	±0.05	±0.05	±0.08	±0.10	see Note	±0.05	±1.00	±1.00	±2.00	±2.00

Note: 20 - 100mm ±2.00mm 101 - 200mm ±3.00mm 201 - 300mm ±4.00mm >301mm ±5.00mm

How to order

FCA - x xx - X xxx - 4 4 06 10 - x

Pitch	Nbr of Conductors	Cable Type	Cable length "CL"	Cable End	Conductor plating
1 = 0.50 mm	04 - 200	D E F	Example: 050 = 50.00mm 100 = 100.00mm	Example: 4 4 06 10 A1 A2 ST1 ST2 4.0 mm 4.0 mm 6.0 mm 10.0 mm ST2 = 00 if Cable Type "D" blank if same as ST1, if different use code like ST1	9 = Tin (leadfree) 5 = Gold flash (on "A1" & "A2" area)
2 = 0.80 mm	06 - 100				
3 = 1.00 mm	02 - 100				
4 = 1.25 mm	02 - 84				
7 = 2.54 mm	03 - 38				