

Moistureproof Plug Type Conforming to MIL-C-5015 and JIS-B-6015



The CE02 series circular connectors are designed to protect connections to electrical equipment from moisture, oil and surges in current which may damage electronic circuitry. The CE02 series is compatible with MIL-C-5015 style connectors such as the D/MS series available from DDK.

FEATURE

- First-make, last-break contact to prevent damage to electronic circuitry.
- Intermateable with MIL-C-5015 style connectors commonly used on existing factory automation and other electrical equipment.
- Designed to offer protection against moisture and oil. A gasket located between the coupling ring and receptacle shell seals the connection. Available water resistant backshells and cable clamps complete the sealed connection. Plug connector is also designed to accept conduit fittings. When used in this method and mated to DDK's CE02-2A series connectors, the entire connection system from the cable to the inside of the equipment is sealed from moisture, oil, and dust.

SPECIFICATION

Current rating	Contact size	#16	#12	#8
	Max.value per contact	13A	23A	46A
Voltage rating	Service rating	A		D
	AC (rms)	500V		900V
	DC	700V		1250V
Withstanding voltage	AC (rms)	2000V		2800V
Insulation resistance	More than 5000M Ω at 500V DC			
Contact resistance	Contact size	#16	#12	#8
	less than m Ω	6	3	2
	Test current	13A	23A	46A
Operating temperature	-55 $^{\circ}$ C to +125 $^{\circ}$ C			

MATERIAL/FINISH

Shell	Aluminum alloy/Zinc plating, Trivalent Chromate finish (Black)
Coupling ring	Aluminum alloy/Zinc plating, Trivalent Chromate finish (Black)
Insert	Diallyl phthalate/Blue
Contact	Copper alloy/Silver plating
Retaining ring	Copper alloy/Nickel plating
Ground lug	Copper alloy/Silver plating
Gasket	Nitrile butadiene rubber/Black

WIRE SIZE

Contact Size	Wire Size
#16	AWG#16-#22
#12	AWG#12-#14
#8	AWG#8-#10

F

CE02-6A

CE02-6A Series

Insert Arrangements

Insert No.	10SL-3	18-10	18-12	20-15	20-29
Arrangements					
Contact Sizes	#16	#12	#16	#12	#16
No. of Contacts	3	4	6	7	17
Grounding Contact Position	CTerminal	DTerminal	DTerminal	DTerminal	NTerminal
Service Rating	A	A	A	A	A
Current Capacity	13A (29.2A)	23A (62.5A)	13A (43.6A)	23A (83.7A)	13A (81.7A)
Insert No.	22-14	22-22	22-23	24-10 (D)	24-10 (G)
Contact Arrangements					
Contact Sizes	#16	#8	#12	#8	#8
No. of Contacts	19	4	8	7	7
Grounding Contact Position	NTerminal	DTerminal	DTerminal	DTerminal	GTerminal
Service Rating	A	A	D (HTerminal) A (Others)	A	A
Current Capacity	13A (88.9A)	46A (125.1A)	23A (90.1A)	46A (167.4A)	46A (167.4A)

F
CE02-6A

Alternate Insert Positions

Insert No.	Contact Sizes/ Number	Non-standard key positions θ			
		W	X	Y	Z
10SL-3	#16 / 3	—	—	—	—
18-10	#12 / 4	—	120°	240°	—
18-12	#16 / 6	80°	—	—	280°
20-15	#12 / 7	80°	—	—	280°
20-29	#16 / 17	80°	—	—	280°
22-14	#16 / 19	80°	—	—	280°
22-22	#8 / 4	—	110°	—	—
22-23	#12 / 8	35°	—	—	—
24-10	#8 / 7	80°	—	—	280°

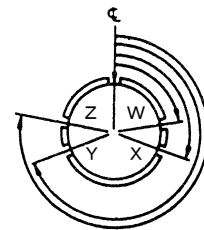

Front View of Socket Insert

CE02-6A Series

Unit : mm

CE02-6A 18-12DSW-D

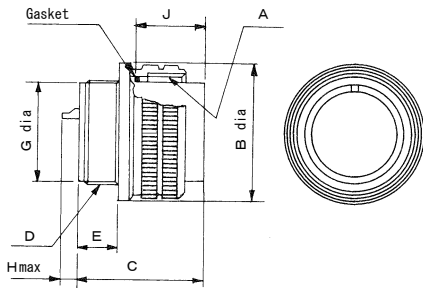
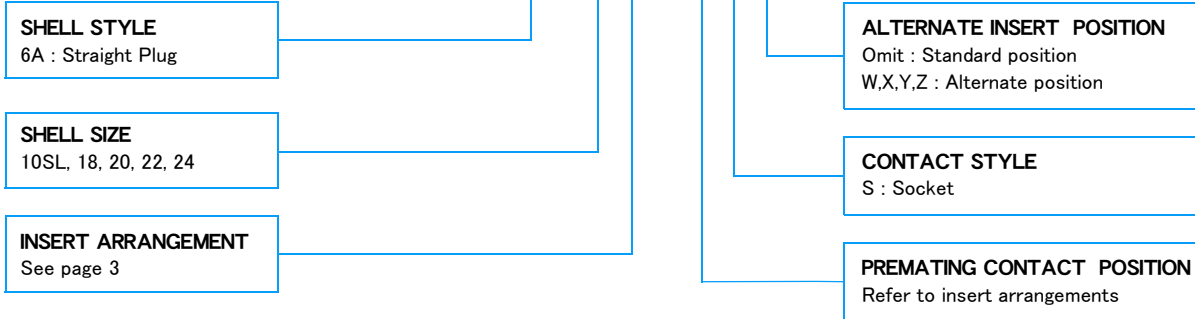

P/N	A	B	C	D	E	G	H	J
CE02-6A10SL-3CS-D	5/8-24UNEF-2B	22.2	23.3	9/16-24UNEF-2A	7.5	12.5	7.0	13.2
CE02-6A18-10DS-D	1 1/8-18UNEF-2B	34.1	33.7	1-20UNEF-2A	11.7	23.5	7.5	19.0
CE02-6A18-12DS-D							7.0	
CE02-6A20-15DS-D	1 1/4-18UNEF-2B	37.3	34.1	11/8-18UNEF-2A	12.2	26.8	7.5	19.0
CE02-6A20-29NS-D							7.0	
CE02-6A22-14NS-D	1 3/8-18UNEF-2B	40.5	34.1	11/4-18UNEF-2A	12.2	29.9	7.0	19.0
CE02-6A22-22DS-D							10.0	
CE02-6A22-23DS-D							7.5	
CE02-6A24-10DS-D	1 1/2-18UNEF-2B	43.6	36.6	13/8-18UNEF-2A	13.4	32.8	8.5	19.4
CE02-6A24-10GS-D							8.5	

F
CE02-6A